

The image shows several pieces of red-painted metal lashing gear. On the left, there are two shackles connected by a pin. On the right, there is a large U-shaped shackle with a silver metal block attached to its end. The metal has a textured, cast appearance. The background is a plain, light-colored surface.

SPANMATERIAAL
LASHING GEAR

Spanmateriaal
Lashing gear

Lewis hijsketting / grade 80 / zwart gelakt

| EN 818-2

Lewis lifting chain / grade 80 / black painted

| EN 818-2

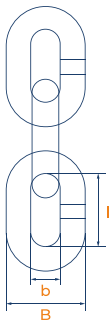

DK = diameter ketting
DK = diameter chain

WLL = veilige belasting (4:1)
WLL = working load limit (4:1)

LC = lashing capaciteit
LC = lashing capacity

| Artikelnr. | DK | B | b | l | WLL | LC | kg/100m |
|------------|----|-------|------|----|--------|--------|---------|
| Part no. | mm | mm | mm | mm | kg | kg | kg/100m |
| 50101006 | 6 | 22,2 | 7,8 | 18 | 1.120 | 2.240 | 80 |
| 50101007 | 7 | 25,9 | 9,1 | 21 | 1.500 | 3.000 | 110 |
| 50101008 | 8 | 29,6 | 10,4 | 24 | 2.000 | 4.000 | 140 |
| 50101010 | 10 | 37,0 | 13,0 | 30 | 3.150 | 6.300 | 220 |
| 50101013 | 13 | 48,1 | 16,9 | 39 | 5.300 | 10.600 | 380 |
| 50101016 | 16 | 59,2 | 20,8 | 48 | 8.000 | 16.000 | 570 |
| 50101020 | 20 | 74,0 | 26,0 | 60 | 12.500 | 25.000 | 870 |
| 50101022 | 22 | 81,4 | 28,6 | 66 | 15.000 | 30.000 | 1.040 |
| 50101026 | 26 | 96,2 | 33,8 | 78 | 21.200 | 42.400 | 1.470 |
| 50101032 | 32 | 118,0 | 41,6 | 96 | 31.500 | 63.000 | 2.240 |

Lewis hijsketting / grade 80 / verzinkt

| EN 818-2

Lewis lifting chain / grade 80 / electro galvanised

| EN 818-2

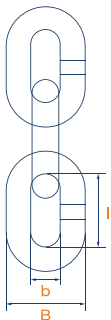

DK = diameter ketting
DK = diameter chain

WLL = veilige belasting (4:1)
WLL = working load limit (4:1)

LC = lashing capaciteit
LC = lashing capacity

| Artikelnr. | DK | B | b | l | WLL | LC | kg/100m |
|------------|----|------|------|----|-------|--------|---------|
| Part no. | mm | mm | mm | mm | kg | kg | kg/100m |
| 50102006 | 6 | 22,2 | 7,8 | 18 | 1.120 | 2.240 | 80 |
| 50102007 | 7 | 25,9 | 9,1 | 21 | 1.500 | 3.000 | 110 |
| 50102008 | 8 | 29,6 | 10,4 | 24 | 2.000 | 4.000 | 140 |
| 50102010 | 10 | 37,0 | 13,0 | 30 | 3.150 | 6.300 | 220 |
| 50102013 | 13 | 48,1 | 16,9 | 39 | 5.300 | 10.600 | 380 |
| 50102016 | 16 | 59,2 | 20,8 | 48 | 8.000 | 16.000 | 570 |

Spanmateriaal
Lashing gear

Containerketting / grade 80 / gelakt
Lashing chain / grade 80 / painted

| Niet voor hijsdoeleinden
| Not for lifting applications



d = diameter
d = diameter

mbl = minimum breekkracht
mbl = minimum breaking load

LB = lengte per bos
LB = length per bundle

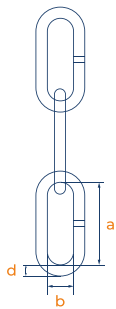

| Artikelnr. | Type | d | a | b | mbl | mbl | LB | kg/100m |
|------------|-----------------------|----|----|----|-----|--------|------|---------|
| Part no. | | mm | mm | mm | kN | kg | m | kg/100m |
| 31011711 | lang / long | 11 | 72 | 19 | 147 | 15.000 | 150 | 210 |
| 31011713 | lang / long | 13 | 80 | 23 | 196 | 20.000 | 150. | 270 |
| 31012016 | half-lang / semi-long | 16 | 62 | 22 | 315 | 32.200 | 150 | 500 |
| 31012019 | half-lang / semi-long | 19 | 76 | 23 | 445 | 45.400 | 150. | 700 |

Lewis ladingspanner / ratel / standaard / G70
Lewis loadbinder with ratchet / standard / G70

| met inkorthaken
| with grab hooks



DK = diameter ketting
DK = diameter chain

LC = lashing capaciteit
LC = lashing capacity

mbl = minimum breekkracht
mbl = minimum breaking load

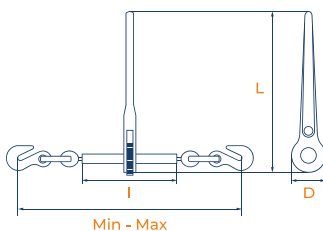

| Artikelnr. | Type | DK | D | L | I | Min | Max | LC | mbl | kg/stuk |
|------------|------------|-------|-----|------|-----|-----|-----|-------|--------|----------|
| Part no. | | mm | mm | mm | mm | mm | mm | kg | kg | kg/piece |
| 5020100810 | L-LBS-810 | 8-10 | 65 | 390 | 255 | 570 | 760 | 2.450 | 8.620 | 4,5 |
| 5020101013 | L-LBS-1013 | 10-13 | 65 | 390 | 255 | 580 | 780 | 4.175 | 15.000 | 5 |
| 5020101316 | L-LBS-1316 | 13-16 | 65. | 390. | 260 | 670 | 860 | 5.900 | 20.800 | 7 |

Spanmateriaal
Lashing gear

Lewis ladingspanner / ratel / uitvalbeveiliging / G80
Lewis loadbinder with ratchet / safety device / G80

| EN 12195-3 / met inkorthaken
| EN 12195-3 / with grab hooks



DK = diameter ketting
DK = diameter chain

LC = lashing capaciteit
LC = lashing capacity

mbl = minimum breekkracht
mbl = minimum breaking load

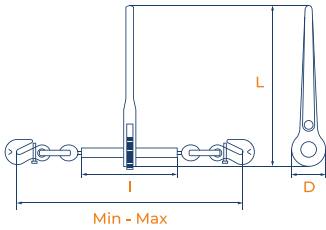

| Artikelnr. | Type | DK | D | L | I | Min | Max | LC | mbl | kg/stuk |
|------------|----------|----|-----|------|-----|-----|-----|--------|--------|----------|
| Part no. | | mm | mm | mm | mm | mm | mm | kg | kg | kg/piece |
| 50202006 | L-LBV-6 | 6 | 43 | 230 | 170 | 410 | 520 | 2.240 | 4.480 | 3 |
| 50202008 | L-LBV-8 | 8 | 65 | 390 | 255 | 590 | 750 | 4.000 | 8.000 | 5 |
| 50202010 | L-LBV-10 | 10 | 65 | 390 | 255 | 610 | 800 | 6.300 | 12.600 | 5,5 |
| 50202013 | L-LBV-13 | 13 | 65. | 390. | 260 | 700 | 850 | 10.600 | 21.200 | 7,5 |
| 50202016 | L-LBV-16 | 16 | 65. | 390. | 260 | 730 | 880 | 16.100 | 32.200 | 10,0 |

Lewis QuickBinder / uitvalbeveiliging / G80
Lewis Quickbinder / safety device / G80

| EN 12195-3 / met inkorthaken
| EN 12195-3 / with grab hooks



DK = diameter ketting
DK = diameter chain

LC = lashing capaciteit
LC = lashing capacity

mbl = minimum breekkracht
mbl = minimum breaking load

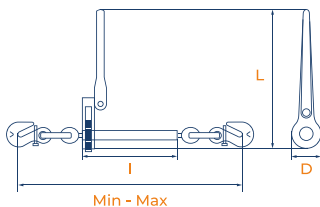

| Artikelnr. | Type | DK | D | L | I | Min | Max | LC | mbl | kg/stuk |
|------------|----------|----|-----|------|-----|-----|-----|--------|--------|----------|
| Part no. | | mm | mm | mm | mm | mm | mm | kg | kg | kg/piece |
| 50221008 | QB 08 | 8 | 65 | 360 | 250 | 590 | 750 | 4.000 | 8.000 | 4,5 |
| 50221010 | QB 10 | 10 | 65 | 360 | 250 | 600 | 790 | 6.300 | 12.600 | 5,5 |
| 50221013 | QB 13 | 13 | 65 | 360 | 260 | 700 | 850 | 10.600 | 21.200 | 7 |
| 50261210 | QB ZH 10 | 10 | 65. | 360. | 250 | 340 | 520 | 6.300 | 12.600 | 3,5 |

Spanmateriaal
Lashing gear

Lewis verbindingschalm / grade 80
Lewis connecting link / grade 80

| EN 1677-1
| EN 1677-1

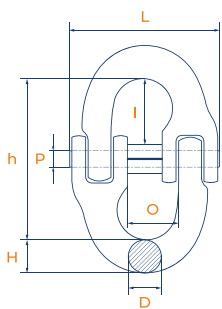

DK = diameter ketting
DK = diameter chain

WLL = veilige belasting (4:1)
WLL = working load limit (4:1)

| Artikelnr. | Type | DK | D | PxL | H | h | I | O | WLL | kg/stuk |
|------------|----------|-----|------|------------|------|------|------|------|--------|----------|
| Part no. | | mm | mm | mm | mm | mm | mm | mm | kg | kg/piece |
| 50301006 | L-VS-6 | 6 | 7 | 4,8 x 39,6 | 7,3 | 42 | 15 | 17 | 1.120 | 0,1 |
| 50301008 | L-VS-7/8 | 7/8 | 9 | 6 x 53,5 | 9,5 | 57 | 22,5 | 20 | 2.000 | 0,16 |
| 50301010 | L-VS-10 | 10 | 10,6 | 7,8 x 66,8 | 12,4 | 68 | 25,2 | 28 | 3.150 | 0,3 |
| 50301013 | L-VS-13 | 13 | 15 | 10 x 80 | 15,3 | 85,2 | 29,8 | 29 | 5.300 | 0,7 |
| 50301016 | L-VS-16 | 16 | 20,3 | 12 x 100 | 20,6 | 104 | 39,8 | 36,3 | 8.000 | 1,15 |
| 50301020 | L-VS-20 | 20 | 23 | 15 x 118 | 24 | 117 | 44 | 41 | 12.500 | 2,1 |
| 50301022 | L-VS-22 | 22 | 27,3 | 17 x 145 | 27,3 | 138 | 53 | 49,5 | 15.000 | 2,87 |
| 50301026 | L-VS-26 | 26 | 31,3 | 20 x 170 | 31 | 157 | 60 | 57,5 | 21.200 | 4,5 |
| 50301032 | L-VS-32 | 32 | 39 | 24 x 210 | 39 | 205 | 78 | 67,5 | 31.500 | 8,21 |

Lewis ooghaak / gesmede veiligheidsklep / grade 80
Lewis eye sling hook / forged safety latch / grade 80

| EN 1677-2
| EN 1677-2

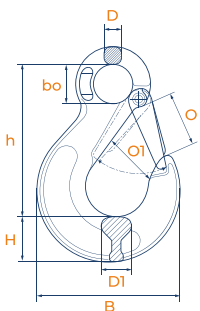

DK = diameter ketting
DK = diameter chain

WLL = veilige belasting (4:1)
WLL = working load limit (4:1)

| Artikelnr. | Type | DK | D | D1 | B | H | h | O | O1 | bo | WLL | kg/stuk |
|------------|----------|-----|------|------|-------|----|-----|----|----|------|-------|----------|
| Part no. | | mm | mm | mm | mm | mm | mm | mm | mm | mm | kg | kg/piece |
| 50402006 | L-OH-6 | 6 | 10 | 17 | 68 | 22 | 78 | 25 | 19 | 19,8 | 1.120 | 0,3 |
| 50402008 | L-OH-7/8 | 7/8 | 11,5 | 18,5 | 83 | 30 | 93 | 28 | 22 | 24,5 | 2.000 | 0,5 |
| 50402010 | L-OH-10 | 10 | 14,5 | 24 | 103 | 35 | 117 | 35 | 29 | 33,5 | 3.150 | 0,95 |
| 50402013 | L-OH-13 | 13 | 17,5 | 29 | 132 | 40 | 150 | 43 | 35 | 42 | 5.300 | 1,6 |
| 50402016 | L-OH-16 | 16 | 22 | 35,5 | 156,5 | 54 | 182 | 51 | 43 | 52 | 8.000 | 3,1 |

Spanmateriaal
Lashing gear

Lewis gaffelhaak / gesmede veiligheidsklep / grade 80 | EN 1677-2
Lewis clevis sling hook / forged safety latch / grade 80 | EN 1677-2



DK = diameter ketting
DK = diameter chain

WLL = veilige belasting (4:1)
WLL = working load limit (4:1)

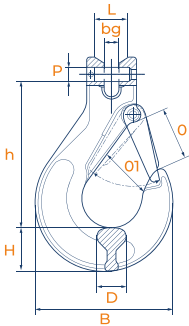

| Artikelnr. | Type | DK | D | PxL | B | bg | H | h | O | O1 | WLL | kg/stuk |
|------------|----------|-----|------|-------------|-------|------|------|-----|------|----|-------|----------|
| Part no. | | mm | mm | mm | mm | mm | mm | mm | mm | mm | kg | kg/piece |
| 50401006 | L-GH-6 | 6 | 15 | 7,7 x 17 | 68 | 6,8 | 22 | 70 | 25 | 19 | 1.120 | 0,25 |
| 50401008 | L-GH-7/8 | 7/8 | 19 | 9 x 23,2 | 87,4 | 9 | 27,8 | 85 | 30,5 | 24 | 2.000 | 0,55 |
| 50401010 | L-GH-10 | 10 | 25 | 12,5 x 29,6 | 106,7 | 12,3 | 34 | 107 | 37,8 | 30 | 3.150 | 1,2 |
| 50401013 | L-GH-13 | 13 | 29,7 | 16 x 38,9 | 130 | 14,3 | 42 | 132 | 48,6 | 38 | 5.300 | 2,1 |
| 50401016 | L-GH-16 | 16 | 38 | 19,7 x 48,8 | 155,5 | 17,2 | 49 | 153 | 54 | 44 | 8.000 | 3,3 |

Lewis inkorthaak / gaffel / grade 80
Lewis clevis grab hook / grade 80

| EN 1677-1
| EN 1677-1



DK = diameter ketting
DK = diameter chain

WLL = veilige belasting (4:1)
WLL = working load limit (4:1)

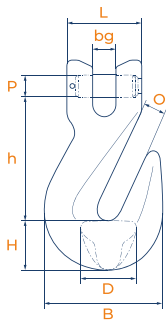

| Artikelnr. | Type | DK | D | PxL | B | bg | H | h | O | WLL | kg/stuk |
|------------|----------|-----|----|---------|------|------|----|------|------|-------|----------|
| Part no. | | mm | mm | mm | mm | mm | mm | mm | mm | kg | kg/piece |
| 50501006 | L-IG-6 | 6 | 22 | 7,6x22 | 46 | 7 | 19 | 44,7 | 7,8 | 1.120 | 0,25 |
| 50501008 | L-IG-7/8 | 7/8 | 32 | 9x25,3 | 50 | 9 | 20 | 51,8 | 10,4 | 2.000 | 0,32 |
| 50501010 | L-IG-10 | 10 | 44 | 12,5x31 | 71,5 | 12 | 30 | 74 | 12,5 | 3.150 | 0,73 |
| 50501013 | L-IG-13 | 13 | 58 | 16x38,9 | 94,5 | 14,8 | 43 | 89 | 15 | 5.300 | 1,6 |
| 50501016 | L-IG-16 | 16 | 66 | 19,7x41 | 114 | 19 | 46 | 112 | 19,2 | 8.000 | 2,8 |

Spanmateriaal
Lashing gear

Lewis inkorthaak / gaffel / uitvalbeveiliging / grade 80 | EN 1677-1
Lewis clevis grab hook / safety device / grade 80 | EN 1677-1

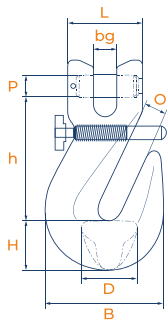

DK = diameter ketting
DK = diameter chain

WLL = veilige belasting (4:1)
WLL = working load limit (4:1)

| Artikelnr. | Type | DK | D | PxL | B | bg | H | h | O | WLL | kg/stuk |
|------------|----------|-----|----|---------|------|------|----|------|------|-------|----------|
| Part no. | | mm | mm | mm | mm | mm | mm | mm | mm | kg | kg/piece |
| 50501406 | L-IV-6 | 6 | 22 | 7,6x22 | 46 | 7 | 19 | 44,7 | 7,8 | 1.120 | 0,25 |
| 50501408 | L-IV-7/8 | 7/8 | 32 | 9x25,3 | 50 | 9 | 20 | 51,8 | 10,4 | 2.000 | 0,32 |
| 50501410 | L-IV-10 | 10 | 44 | 12,5x31 | 71,5 | 12 | 30 | 74 | 12,5 | 3.150 | 0,73 |
| 50501413 | L-IV-13 | 13 | 58 | 16x38,9 | 94,5 | 14,8 | 43 | 89 | 15 | 5.300 | 1,6 |
| 50501416 | L-IV-16 | 16 | 66 | 19,7x41 | 114 | 19 | 46 | 112 | 19,2 | 8.000 | 2,8 |

Lewis inkortklauw / gaffel / grade 80 | EN 1677-1
Lewis clevis shortening clutch / grade 80 | EN 1677-1

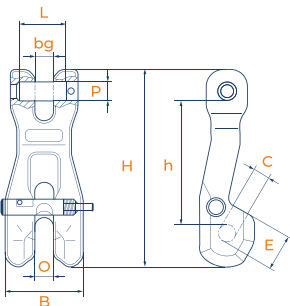

DK = diameter ketting
DK = diameter chain

WLL = veilige belasting (4:1)
WLL = working load limit (4:1)

| Artikelnr. | Type | DK | PxL | B | bg | C | E | H | h | O | WLL | kg/stuk |
|------------|----------|-----|----------|----|------|------|----|-----|-----|------|-------|----------|
| Part no. | | mm | mm | mm | mm | mm | mm | mm | mm | mm | kg | kg/piece |
| 50503006 | L-KG-6 | 6 | 7,5x16,8 | 33 | 7 | 7 | 12 | 73 | 48 | 7 | 1.120 | 0,25 |
| 50503008 | L-KG-7/8 | 7/8 | 9x24 | 45 | 9 | 9 | 17 | 101 | 66 | 9 | 2.000 | 0,41 |
| 50503010 | L-KG-10 | 10 | 13x32 | 55 | 12,8 | 12 | 28 | 137 | 89 | 12,8 | 3.150 | 0,98 |
| 50503013 | L-KG-13 | 13 | 16,1x41 | 75 | 17 | 14,8 | 34 | 177 | 116 | 17 | 5.300 | 2 |

Spanmateriaal
Lashing gear

Lewis inkortklaus / gaffel / beveiliging / grade 80 | EN 1677-1
Lewis clevis shortening clutch / safety pawl / grade 80 | EN 1677-1



DK = diameter ketting
DK = diameter chain

WLL = veilige belasting (4:1)
WLL = working load limit (4:1)

| Artikelnr. | Type | DK | PxL | B | bg | C | E | H | h | O | WLL | kg/stuk |
|------------|--------|----|----------|------|-----|-----|----|-----|----|-----|-------|----------|
| Part no. | | mm | mm | mm | mm | mm | mm | mm | mm | mm | kg | kg/piece |
| 50503406 | L-KV-6 | 6 | 7,5x16,8 | 40 | 8 | 7,5 | 12 | 91 | 54 | 8,5 | 1.120 | 0,6 |
| 50503408 | L-KV-8 | 8 | 9x24 | 46,5 | 9,5 | 11 | 17 | 109 | 69 | 9,5 | 2.000 | 0,90 |

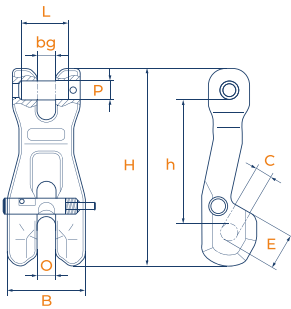

Lewis inkorthaak / oog / beveiliging / grade 80 | EN 1677-1
Lewis eye grab hook / safety device / grade 80 | EN 1677-1



DK = diameter ketting
DK = diameter chain

WLL = veilige belasting (4:1)
WLL = working load limit (4:1)

| Artikelnr. | Type | DK | A | D | B | E | H | h | O | WLL | kg/stuk |
|------------|-----------|-----|------|----|----|----|----|----|----|-------|----------|
| Part no. | | mm | mm | mm | mm | mm | mm | mm | mm | kg | kg/piece |
| 50502408 | L-IOV-7/8 | 7/8 | 10,4 | 31 | 50 | 11 | 23 | 43 | 15 | 2.000 | 0,35 |
| 50502410 | L-IOV-10 | 10 | 12,5 | 40 | 65 | 12 | 30 | 52 | 22 | 3.150 | 0,60 |
| 50502413 | L-IOV-13 | 13 | 15 | 50 | 85 | 16 | 37 | 65 | 26 | 5.300 | 1,3 |

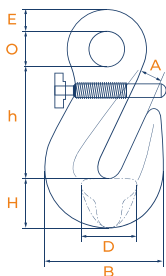

Spanmateriaal
Lashing gear

Lewis aanlashaak / grade 80
Lewis weld-on hook / grade 80



WLL = veilige belasting (4:1)
WLL = working load limit (4:1)

| Artikelnr. | Type | B | C | H | L | M | O | WLL | kg/stuk |
|------------|---------|----|------|-----|-----|------|------|--------|----------|
| Part no. | | mm | mm | mm | mm | mm | mm | kg | kg/piece |
| 50741001 | L-AH-6 | 25 | 59,5 | 76 | 97 | 19 | 25 | 1.120 | 0,48 |
| 50741002 | L-AH-8 | 34 | 67 | 92 | 114 | 23,3 | 26,5 | 2.000 | 0,85 |
| 50741003 | L-AH-10 | 36 | 75 | 106 | 129 | 33,6 | 30,5 | 3.000 | 1,12 |
| 50741005 | L-AH-13 | 45 | 94 | 136 | 171 | 44 | 34,5 | 5.000 | 2,50 |
| 50741008 | L-AH-16 | 51 | 94 | 140 | 177 | 44 | 34,5 | 8.000 | 3,2 |
| 50741010 | L-AH-18 | 53 | 135 | 175 | 223 | 54,7 | 51 | 10.000 | 5,2 |

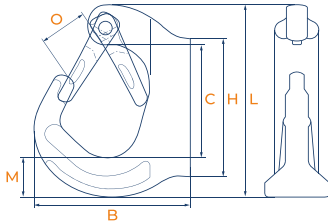

Lewis aanlasoog / grade 80
Lewis weld-on ring / grade 80

| Zonder veer
| Without spring



WLL = veilige belasting (4:1)
WLL = working load limit (4:1)

| Artikelnr. | Type | D | b | C | E | h | L | WLL | kg/stuk |
|------------|-----------|----|----|----|------|----|-------|--------|----------|
| Part no. | | mm | mm | mm | mm | mm | mm | kg | kg/piece |
| 50761001 | ASP-K-01 | 13 | 41 | 35 | 37 | 37 | 65,5 | 1.120 | 0,4 |
| 50761002 | ASP-K-02 | 14 | 42 | 37 | 40 | 48 | 74 | 2.000 | 0,5 |
| 507610032 | ASP-K-032 | 18 | 45 | 40 | 42,5 | 46 | 77 | 3.150 | 0,7 |
| 50761005 | ASP-K-05 | 22 | 55 | 52 | 61 | 53 | 96 | 5.300 | 1,5 |
| 50761008 | ASP-K-08 | 26 | 70 | 57 | 70 | 67 | 114,5 | 8.000 | 2,5 |
| 50761015 | ASP-K-15 | 34 | 97 | 77 | 90 | 92 | 154 | 15.000 | 5,9 |

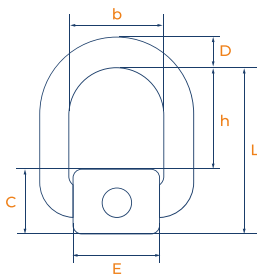

Spanmateriaal
Lashing gear

Lewis self-locking haak / gaffel / grade 80
Lewis clevis self-locking hook / grade 80

| EN 1677-3
| EN 1677-3



DK = diameter ketting
DK = diameter chain

WLL = veilige belasting (4:1)
WLL = working load limit (4:1)

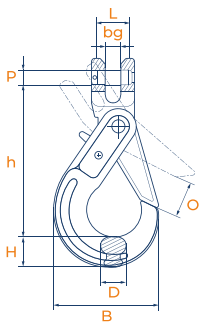

| Artikelnr. | Type | DK | D | PxL | B | bg | H | h | O | WLL | kg/stuk |
|------------|----------|-----|----|----------|-----|------|----|-----|----|-------|----------|
| Part no. | | mm | mm | mm | mm | mm | mm | mm | mm | kg | kg/piece |
| 50601006 | L-SG-6 | 6 | 15 | 7,6x22,2 | 70 | 7 | 21 | 97 | 30 | 1.120 | 0,5 |
| 50601008 | L-SG-7/8 | 7/8 | 19 | 8,9x26,6 | 89 | 9 | 28 | 115 | 40 | 2.000 | 0,8 |
| 50601010 | L-SG-10 | 10 | 26 | 13x32,8 | 108 | 12 | 29 | 141 | 51 | 3.150 | 1,5 |
| 50601013 | L-SG-13 | 13 | 32 | 16x41,3 | 137 | 14,8 | 43 | 177 | 68 | 5.300 | 2,8 |
| 50601016 | L-SG-16 | 16 | 38 | 20x52,6 | 170 | 17,2 | 51 | 205 | 77 | 8.000 | 5,6 |

Lewis wartelhaak / klep / gelagerd / grade 80
Lewis swivel hook / safety latch / bearing / grade 80

| EN 1677-2
| EN 1677-2



DK = diameter ketting
DK = diameter chain

WLL = veilige belasting (4:1)
WLL = working load limit (4:1)

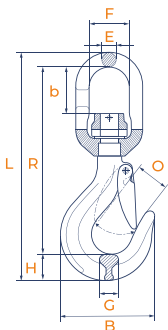

| Artikelnr. | Type | DK | B | b | R | E | F | G | H | L | O | WLL | kg/stuk |
|------------|------------|-------|-----|----|-----|----|----|----|----|-----|----|--------|----------|
| Part no. | | mm | mm | mm | mm | mm | mm | mm | mm | mm | mm | kg | kg/piece |
| 50404006 | L-WK-6 | 6 | 72 | 29 | 136 | 11 | 33 | 16 | 20 | 166 | 25 | 1.120 | 0,65 |
| 50404008 | L-WK-7/8 | 7/8 | 88 | 42 | 165 | 14 | 36 | 21 | 25 | 205 | 26 | 2.000 | 0,95 |
| 50404010 | L-WK-10 | 10 | 105 | 50 | 204 | 17 | 42 | 23 | 31 | 252 | 31 | 3.150 | 1,71 |
| 50404013 | L-WK-13 | 13 | 135 | 58 | 242 | 19 | 50 | 32 | 40 | 296 | 38 | 5.300 | 2,97 |
| 50404016 | L-WK-16 | 16 | 160 | 62 | 280 | 24 | 60 | 38 | 45 | 357 | 43 | 8.000 | 5,3 |
| 50404020 | L-WK-18/20 | 18/20 | 191 | 90 | 356 | 25 | 74 | 49 | 50 | 434 | 56 | 12.500 | 9,5 |

Spanmateriaal
Lashing gear

Lewis glijhaak / grade 80

| EN 1677-2

Lewis gliding choker hook / grade 80

| EN 1677-2

WLL = veilige belasting (4:1)
WLL = working load limit (4:1)

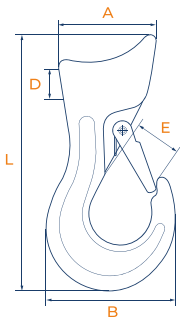

| Artikelnr. | Type | A | D | B | E | L | WLL | kg/stuk |
|------------|----------|------|----|----|----|-------|-------|----------|
| Part no. | | mm | mm | mm | mm | mm | kg | kg/piece |
| 50740016 | L-G-1.6T | 50 | 17 | 71 | 18 | 132 | 1.600 | 0,68 |
| 50740020 | L-G-2.0T | 63,5 | 22 | 79 | 20 | 151,3 | 2.000 | 1,21 |

Lewis gesmede klepset voor Lewis aanlashaak
Lewis forged latch set for Lewis weld-on hook

| Inhoud set: klep, veer en stiften

| Set contains: latch, spring and pins



| Artikelnr. | Type | Voor type | kg/stuk |
|------------|---------|-----------|----------|
| Part no. | | For type | kg/piece |
| 50951401 | L-KA-6 | L-AH-6 | 0,04 |
| 50951402 | L-KA-8 | L-AH-8 | 0,09 |
| 50951403 | L-KA-10 | L-AH-10 | 0,14 |
| 50951405 | L-KA-13 | L-AH-13 | 0,33 |
| 50951408 | L-KA-16 | L-AH-16 | 0,33 |
| 50951410 | L-KA-18 | L-AH-18 | 0,56 |

Spanmateriaal Lashing gear

Lewis reserveset voor Lewis verbindingsschalm Lewis spare set for Lewis connecting link

| Inhoud set: pin en bus
| Set contains: pin and bush

DK = diameter ketting
DK = diameter chain



| Artikelnr. | Type | Voor type | DK | kg/stuk |
|------------|----------|-----------|-----|----------|
| Part no. | | For type | mm | kg/piece |
| 50952006 | L-PB-6 | L-VS-6 | 6 | 0,03 |
| 50952008 | L-PB-7/8 | L-VS-7/8 | 7/8 | 0,035 |
| 50952010 | L-PB-10 | L-VS-10 | 10 | 0,06 |
| 50952013 | L-PB-13 | L-VS-13 | 13 | 0,1 |
| 50952016 | L-PB-16 | L-VS-16 | 16 | 0,135 |

Lewis gesmede klepset voor Lewis gaffel- of ooghaak Lewis forged latch set for Lewis sling hook

| Inhoud set: klep, veer en stift
| Set contains: latch, spring and pin

DK = diameter ketting
DK = diameter chain



| Artikelnr. | Type | Voor type | DK | kg/stuk |
|------------|----------|---------------------|-----|----------|
| Part no. | | For type | mm | kg/piece |
| 50951006 | L-KS-6 | L-GH-6 & L-OH-6 | 6 | 0,03 |
| 50951008 | L-KS-7/8 | L-GH-7/8 & L-OH-7/8 | 7/8 | 0,035 |
| 50951010 | L-KS-10 | L-GH-10 & L-OH-10 | 10 | 0,06 |
| 50951013 | L-KS-13 | L-GH-13 & L-OH-13 | 13 | 0,1 |
| 50951016 | L-KS-16 | L-GH-16 & L-OH-16 | 16 | 0,135 |

Spanmateriaal
Lashing gear

Identificatieplaatje / grade 100
Identification tag / grade 100



| Artikelnr. | Type | Voor type | kg/stuk |
|------------|----------------------------|---------------------------|----------|
| Part no. | | For type | kg/piece |
| 50955210 | zonder ring / without ring | leng / 1 leg | 0,12 |
| 50955220 | zonder ring / without ring | 2-3-4 sprong / 2-3-4 legs | 0,12 |
| 50955230 | met ring / with ring | leng / 1 leg | 0,15 |
| 50955240 | met ring / with ring | 2-3-4 sprong / 2-3-4 legs | 0,15 |

Identificatieplaatje / grade 80
Identification tag / grade 80



| Artikelnr. | Type | Voor type | kg/stuk |
|------------|----------------------------|---------------------------|----------|
| Part no. | | For type | kg/piece |
| 50955010 | zonder ring / without ring | leng / 1 leg | 0,12 |
| 50955020 | zonder ring / without ring | 2-3-4 sprong / 2-3-4 legs | 0,12 |
| 50955030 | met ring / with ring | leng / 1 leg | 0,15 |
| 50955040 | met ring / with ring | 2-3-4 sprong / 2-3-4 legs | 0,15 |
| 50955050 | losse ring / ring only | | 0,03 |

Spanmateriaal Lashing gear

Lewis palset voor Lewis self-locking haak Lewis locking device set for Lewis self-locking hook

| Inhoud set: pal, veer en stift
| Set contains: locking devise, spring and pin

DK = diameter ketting
DK = diameter chain



| Artikelnr. | Type | Voor type | DK | kg/stuk |
|------------|----------|-----------|-----|----------|
| Part no. | | For type | mm | kg/piece |
| 50953006 | L-PS-6 | L-SG-6 | 6 | 0,03 |
| 50953008 | L-PS-7/8 | L-SG-7/8 | 7/8 | 0,04 |
| 50953010 | L-PS-10 | L-SG-10 | 10 | 0,06 |
| 50953013 | L-PS-13 | L-SG-13 | 13 | 0,10 |
| 50953016 | L-PS-16 | L-SG-16 | 16 | 0,14 |

Identificatieplaatje / lashing Identification tag / lashing



| Artikelnr. | Type | kg/stuk |
|------------|----------------------------|----------|
| Part no. | | kg/piece |
| 50955410 | zonder ring / without ring | 0,12 |
| 50955420 | met ring / with ring | 0,15 |



Spanmateriaal Lashing gear

Lewis borgpenset voor Lewis inkorthaak Lewis safety device set for Lewis grab hook

| Inhoud set: pin, veer en borgdop
| Set contains: pin, spring and button

DK = diameter ketting
DK = diameter chain



| Artikelnr. | Type | Voor type | DK | kg/stuk |
|------------|----------|-----------|-----|----------|
| Part no. | | For type | mm | kg/piece |
| 50954006 | L-BG-6 | L-IV-6 | 6 | 0,01 |
| 50954008 | L-BG-7/8 | L-IV-7/8 | 7/8 | 0,02 |
| 50954010 | L-BG-10 | L-IV-10 | 10 | 0,025 |
| 50954013 | L-BG-13 | L-IV-13 | 13 | 0,03 |
| 50954016 | L-BG-16 | L-IV-16 | 16 | 0,04 |