

# Lewis Gear®

LIFTING • LASHING • RIGGING



LIFTING

LASHING

RIGGING



*Lewis Gear*<sup>®</sup>

---

LIFTING • LASHING • RIGGING

---



# Inhoudsopgave • Index

---

Lewis hijsmateriaal G80	Lewis lifting gear G80	6
Lewis hijsmateriaal G100	Lewis lifting gear G100	22
Lewis hijsogen	Lewis lifting points	32
Lewis rigging materiaal	Lewis rigging gear	36
Lewis ladingspanners	Lewis loadbinders	44
Lewis takels	Lewis hoists	48



LEWIS  
HIJSMATERIAAL G80

LEWIS  
LIFTING GEAR G80



**Lewis hijsketting / G80 / zwart gelakt**  
**Lewis lifting chain / G80 / black painted**

| EN 818-2

| EN 818-2

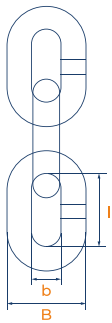
DK = diameter ketting  
DK = diameter chainWLL = veilige belasting (4:1)  
WLL = working load limit (4:1)LC = lashing capaciteit  
LC = lashing capacity

Artikelnr.	DK	B	b	l	WLL	LC	kg/100m
Part no.	mm	mm	mm	mm	kg	kg	kg/100m
50101006	6	22,2	7,8	18	1.120	2.240	80
50101007	7	25,9	9,1	21	1.500	3.000	110
50101008	8	29,6	10,4	24	2.000	4.000	140
50101010	10	37,0	13,0	30	3.150	6.300	220
50101013	13	48,1	16,9	39	5.300	10.600	380
50101016	16	59,2	20,8	48	8.000	16.000	570
50101020	20	74,0	26,0	60	12.500	25.000	870
50101022	22	81,4	28,6	66	15.000	30.000	1.040
50101026	26	96,2	33,8	78	21.200	42.400	1.470
50101032	32	118,0	41,6	96	31.500	63.000	2.240

**Lewis hijsketting / G80 / verzinkt**  
**Lewis lifting chain / G80 / electro galvanised**

| EN 818-2

| EN 818-2

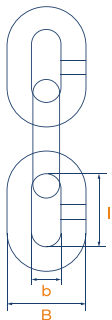
DK = diameter ketting  
DK = diameter chainWLL = veilige belasting (4:1)  
WLL = working load limit (4:1)LC = lashing capaciteit  
LC = lashing capacity

Artikelnr.	DK	B	b	l	WLL	LC	kg/100m
Part no.	mm	mm	mm	mm	kg	kg	kg/100m
50102006	6	22,2	7,8	18	1.120	2.240	80
50102007	7	25,9	9,1	21	1.500	3.000	110
50102008	8	29,6	10,4	24	2.000	4.000	140
50102010	10	37,0	13,0	30	3.150	6.300	220
50102013	13	48,1	16,9	39	5.300	10.600	380
50102016	16	59,2	20,8	48	8.000	16.000	570

**Lewis takelketting / G80 / verzinkt**

| EN 818-7

**Lewis hoist chain / G80 / electro galvanised**

| EN 818-7

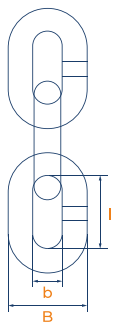

WLL = veilige belasting (4:1)  
WLL = working load limit (4:1)

Artikelnr.	D	B	b	l	WLL	kg/100m
Part no.	mm	mm	mm	mm	kg	kg/100m
489090500412	4	13,2	5,2	12,0	500	36
489090500618	6	19,8	7,8	18,0	1.150	80
48909050063191	6,3	22,0	7,8	19,1	1.300	86
489090500721	7	23,1	8,7	21,0	1.500	108
4890905007212	7,1	25,0	8,8	21,2	1.600	108
489090500824	8	27,2	9,6	24,0	2.000	149
489090500927	9	29,7	11,5	27,0	2.500	185
489090501030	10	34,0	12,0	30,0	3.200	219
489090550618	6 (zwart) / 6 (black)	20,4	7,2	18,0	1.150	80

**Lewis verbindingschalm / G80**

| EN 1677-1

**Lewis connecting link / G80**

| EN 1677-1

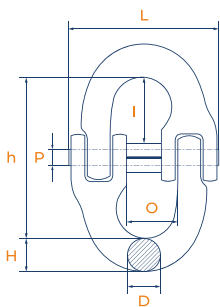

DK = diameter ketting  
DK = diameter chain

WLL = veilige belasting (4:1)  
WLL = working load limit (4:1)

Artikelnr.	Type	DK	D	PxL	H	h	l	O	WLL	kg/stuk
Part no.		mm	mm	mm	mm	mm	mm	mm	kg	kg/piece
50301006	L-VS-6	6	7	4,8 x 39,6	7,3	42	15	17	1.120	0,1
50301008	L-VS-7/8	7/8	9	6 x 53,5	9,5	57	22,5	20	2.000	0,16
50301010	L-VS-10	10	10,6	7,8 x 66,8	12,4	68	25,2	28	3.150	0,3
50301013	L-VS-13	13	15	10 x 80	15,3	85,2	29,8	29	5.300	0,7
50301016	L-VS-16	16	20,3	12 x 100	20,6	104	39,8	36,3	8.000	1,15
50301020	L-VS-20	20	23	15 x 118	24	117	44	41	12.500	2,1
50301022	L-VS-22	22	27,3	17 x 145	27,3	138	53	49,5	15.000	2,87
50301026	L-VS-26	26	31,3	20 x 170	31	157	60	57,5	21.200	4,5
50301032	L-VS-32	32	39	24 x 210	39	205	78	67,5	31.500	8,21



**Lewis verbindingsschalm / hijsbanden / G80**  
**Lewis connecting link for webbing / G80**

| EN 1677-1  
| EN 1677-1



DK = diameter ketting  
DK = diameter chain

WLL = veilige belasting (4:1)  
WLL = working load limit (4:1)

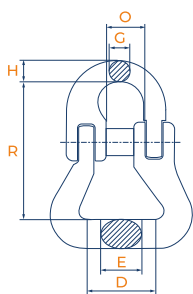

Artikelnr.	Type	DK	D	R	E	G	H	O	WLL	kg/stuk
Part no.		mm	mm	mm	mm	mm	mm	mm	kg	kg/piece
50302006	L-VH-6	6	38	56	18	7	7,5	15,5	1.120	0,2
50302008	L-VH-7/8	7/8	38	64	24	8,5	9	20	2.000	0,3
50302010	L-VH-10	10	45	86	30,5	11	12	24	3.150	0,53
50302013	L-VH-13	13	51	94	36,8	16,5	16,5	28,5	5.300	1,03

**Lewis topschalm / 1/2-sprong / G80**  
**Lewis masterlink / 1/2 legs / G80**

| EN 1677-4  
| EN 1677-4



DK-1 = diameter ketting bij kettingleng  
DK-1 = diameter chain 1-leg

DK-2 = diameter ketting bij 2-sprong  
DK-2 = diameter chain 2-legs

WLL = veilige belasting (4:1)  
WLL = working load limit (4:1)

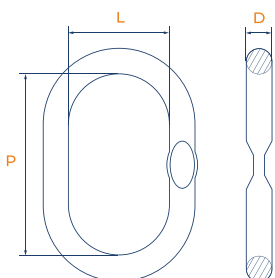

Artikelnr.	Type	DK-1	DK-2	D	L	P	WLL	kg/stuk
Part no.		mm	mm	mm	mm	mm	kg	kg/piece
50341007	L-76-8	6/7	6	13	60	110	1.600	0,34
50341008	L-87-8	8	7	16	60	110	2.120	0,54
50341010	L-108-8	10	8	18	75	135	3.150	0,82
50341013	L-1310-8	13	10	22	90	160	5.300	1,5
50341016	L-1613-8	16	13	26	100	180	8.000	2,3
50341018	L-1816-8	18	16	32	110	200	11.200	3,95

**Lewis topschalm / 3/4-sprong / G80**  
**Lewis masterlink / 3/4 legs / G80**

| EN 1677-4

| EN 1677-4

DK = diameter ketting  
DK = diameter chain

WLL = veilige belasting (4:1)  
WLL = working load limit (4:1)

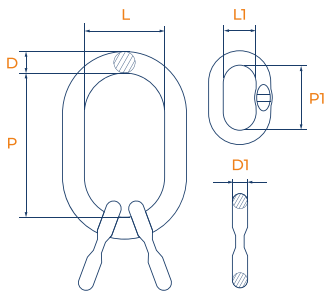

Artikelnr.	Type	DK	D	D1	L	L1	P	P1	WLL	kg/stuk
Part no.		mm	mm	mm	mm	mm	mm	mm	kg	kg/piece
50342007	L-7-8	6/7	18	13	75	38	135	50	3.150	1,24
50342008	L-8-8	8	22	16	90	34	160	70	4.250	2,20
50342010	L-10-8	10	26	18	100	40	180	85	6.700	3,40
50342013	L-13-8	13	32	22	110	50	200	115	11.200	6,10
50342016	L-16-8	16	36	26	140	65	260	140	17.000	9,98

**Lewis ooghaak / gesmede veiligheidsklep / G80**  
**Lewis eye sling hook / forged safety latch / G80**

| EN 1677-2

| EN 1677-2

DK = diameter ketting  
DK = diameter chain

WLL = veilige belasting (4:1)  
WLL = working load limit (4:1)

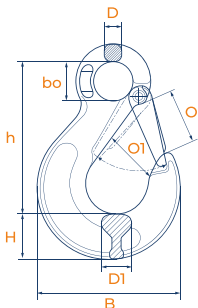

Artikelnr.	Type	DK	D	D1	B	H	h	O	O1	bo	WLL	kg/stuk
Part no.		mm	mm	mm	mm	mm	mm	mm	mm	mm	kg	kg/piece
50402006	L-OH-6	6	10	17	68	22	78	25	19	19,8	1.120	0,3
50402008	L-OH-7/8	7/8	11,5	18,5	83	30	93	28	22	24,5	2.000	0,5
50402010	L-OH-10	10	14,5	24	103	35	117	35	29	33,5	3.150	0,95
50402013	L-OH-13	13	17,5	29	132	40	150	43	35	42	5.300	1,6
50402016	L-OH-16	16	22	35,5	156,5	54	182	51	43	52	8.000	3,1

**Lewis gaffelhaak / gesmede veiligheidsklep / G80**  
**Lewis clevis sling hook / forged safety latch / G80**

| EN 1677-2  
| EN 1677-2



DK = diameter ketting  
DK = diameter chain

WLL = veilige belasting (4:1)  
WLL = working load limit (4:1)

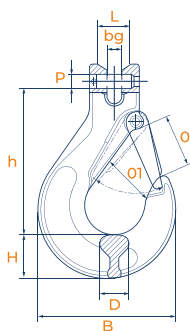

Artikelnr.	Type	DK	D	PxL	B	bg	H	h	O	O1	WLL	kg/stuk
Part no.		mm	mm	mm	mm	mm	mm	mm	mm	mm	kg	kg/piece
50401006	L-GH-6	6	15	7,7 x 17	68	6,8	22	70	25	19	1.120	0,25
50401008	L-GH-7/8	7/8	19	9 x 23,2	87,4	9	27,8	85	30,5	24	2.000	0,55
50401010	L-GH-10	10	25	12,5 x 29,6	106,7	12,3	34	107	37,8	30	3.150	1,2
50401013	L-GH-13	13	29,7	16 x 38,9	130	14,3	42	132	48,6	38	5.300	2,1
50401016	L-GH-16	16	38	19,7 x 48,8	155,5	17,2	49	153	54	44	8.000	3,3

**Lewis self-locking haak / gaffel / G80**  
**Lewis clevis self-locking hook / G80**

| EN 1677-3  
| EN 1677-3



DK = diameter ketting  
DK = diameter chain

WLL = veilige belasting (4:1)  
WLL = working load limit (4:1)

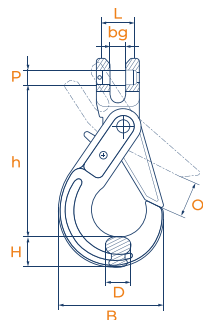

Artikelnr.	Type	DK	D	PxL	B	bg	H	h	O	WLL	kg/stuk
Part no.		mm	mm	mm	mm	mm	mm	mm	mm	kg	kg/piece
50601006	L-SG-6	6	15	7,6x22,2	70	7	21	97	30	1.120	0,5
50601008	L-SG-7/8	7/8	19	8,9x26,6	89	9	28	115	40	2.000	0,8
50601010	L-SG-10	10	26	13x32,8	108	12	29	141	51	3.150	1,5
50601013	L-SG-13	13	32	16x41,3	137	14,8	43	177	68	5.300	2,8
50601016	L-SG-16	16	38	20x52,6	170	17,2	51	205	77	8.000	5,6

**Lewis wartelhaak / klep / gelagerd / G80**  
**Lewis swivel hook / safety latch / bearing / G80**

| EN 1677-2  
| EN 1677-2



DK = diameter ketting  
DK = diameter chain

WLL = veilige belasting (4:1)  
WLL = working load limit (4:1)

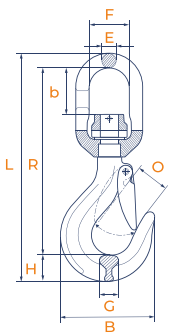

Artikelnr.	Type	DK	B	b	R	E	F	G	H	L	O	WLL	kg/stuk
Part no.		mm	mm	mm	mm	mm	mm	mm	mm	mm	mm	kg	kg/piece
50404006	L-WK-6	6	72	29	136	11	33	16	20	166	25	1.120	0,65
50404008	L-WK-7/8	7/8	88	42	165	14	36	21	25	205	26	2.000	0,95
50404010	L-WK-10	10	105	50	204	17	42	23	31	252	31	3.150	1,71
50404013	L-WK-13	13	135	58	242	19	50	32	40	296	38	5.300	2,97
50404016	L-WK-16	16	160	62	280	24	60	38	45	357	43	8.000	5,3
50404020	L-WK-18/20	18/20	191	90	356	25	74	49	50	434	56	12.500	9,5

**Lewis inkortklaauw / gaffel / G80**  
**Lewis clevis shortening clutch / G80**

| EN 1677-1  
| EN 1677-1



DK = diameter ketting  
DK = diameter chain

WLL = veilige belasting (4:1)  
WLL = working load limit (4:1)

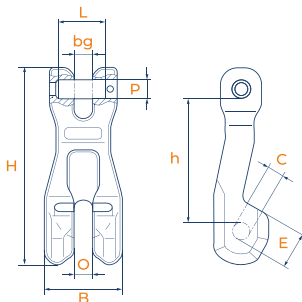

Artikelnr.	Type	DK	PxL	B	bg	C	E	H	h	O	WLL	kg/stuk
Part no.		mm	mm	mm	mm	mm	mm	mm	mm	mm	kg	kg/piece
50503006	L-KG-6	6	7,5x16,8	33	7	7	12	73	48	7	1.120	0,25
50503008	L-KG-7/8	7/8	9x24	45	9	9	17	101	66	9	2.000	0,41
50503010	L-KG-10	10	13x32	55	12,8	12	28	137	89	12,8	3.150	0,98
50503013	L-KG-13	13	16,1x41	75	17	14,8	34	177	116	17	5.300	2

**Lewis inkortklauw / gaffel / beveiliging / G80**

| EN 1677-1

**Lewis clevis shortening clutch / safety pawl / G80**

| EN 1677-1



DK = diameter ketting  
DK = diameter chain

WLL = veilige belasting (4:1)  
WLL = working load limit (4:1)

Artikelnr.	Type	DK	PxL	B	bg	C	E	H	h	O	WLL	kg/stuk
Part no.		mm	mm	mm	mm	mm	mm	mm	mm	mm	kg	kg/piece
50503406	L-KV-6	6	7,5x16,8	40	8	7,5	12	91	54	8,5	1.120	0,6
50503408	L-KV-8	8	9x24	46,5	9,5	11	17	109	69	9,5	2.000	0,90

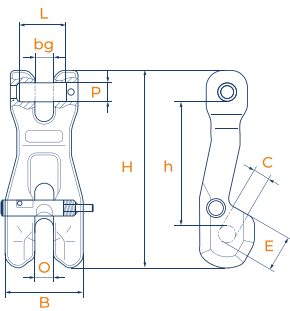

**Lewis inkorthaak / gaffel / G80**

| EN 1677-1

**Lewis clevis grab hook / G80**

| EN 1677-1



DK = diameter ketting  
DK = diameter chain

WLL = veilige belasting (4:1)  
WLL = working load limit (4:1)

Artikelnr.	Type	DK	D	PxL	B	bg	H	h	O	WLL	kg/stuk
Part no.		mm	mm	mm	mm	mm	mm	mm	mm	kg	kg/piece
50501006	L-IG-6	6	22	7,6x22	46	7	19	44,7	7,8	1.120	0,25
50501008	L-IG-7/8	7/8	32	9x25,3	50	9	20	51,8	10,4	2.000	0,32
50501010	L-IG-10	10	44	12,5x31	71,5	12	30	74	12,5	3.150	0,73
50501013	L-IG-13	13	58	16x38,9	94,5	14,8	43	89	15	5.300	1,6
50501016	L-IG-16	16	66	19,7x41	114	19	46	112	19,2	8.000	2,8

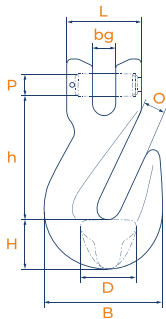

**Lewis inkorthaak / gaffel / uitvalbeveiliging / G80**  
**Lewis clevis grab hook / safety device / G80**

| EN 1677-1  
| EN 1677-1



DK = diameter ketting  
DK = diameter chain

WLL = veilige belasting (4:1)  
WLL = working load limit (4:1)

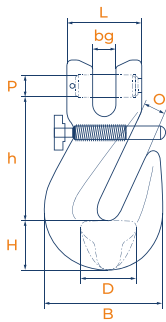

Artikelnr.	Type	DK	D	PxL	B	bg	H	h	O	WLL	kg/stuk
Part no.		mm	mm	mm	mm	mm	mm	mm	mm	kg	kg/piece
50501406	L-IV-6	6	22	7,6x22	46	7	19	44,7	7,8	1.120	0,25
50501408	L-IV-7/8	7/8	32	9x25,3	50	9	20	51,8	10,4	2.000	0,32
50501410	L-IV-10	10	44	12,5x31	71,5	12	30	74	12,5	3.150	0,73
50501413	L-IV-13	13	58	16x38,9	94,5	14,8	43	89	15	5.300	1,6
50501416	L-IV-16	16	66	19,7x41	114	19	46	112	19,2	8.000	2,8

**Lewis inkorthaak / oog / beveiliging / G80**  
**Lewis eye grab hook / safety device / G80**

| EN 1677-1  
| EN 1677-1



DK = diameter ketting  
DK = diameter chain

WLL = veilige belasting (4:1)  
WLL = working load limit (4:1)

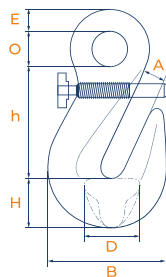

Artikelnr.	Type	DK	A	D	B	E	H	h	O	WLL	kg/stuk
Part no.		mm	mm	mm	mm	mm	mm	mm	mm	kg	kg/piece
50502408	L-IOV-7/8	7/8	10,4	31	50	11	23	43	15	2.000	0,35
50502410	L-IOV-10	10	12,5	40	65	12	30	52	22	3.150	0,60
50502413	L-IOV-13	13	15	50	85	16	37	65	26	5.300	1,3

**Lewis ketting-kabel verbinder / G80**  
**Lewis chain-rope connector / G80**

| EN 1677-1  
| EN 1677-1



DK = diameter ketting  
DK = diameter chain

LC = lashing capaciteit  
LC = lashing capacity

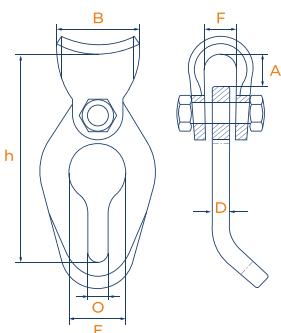

Artikelnr.	Type	DK	A	D	B	E	F	h	O	LC	kg/stuk
Part no.		mm	mm	mm	mm	mm	mm	mm	mm	kg	kg/piece
50701008	L-KK-7/8	7/8	20	10,5	49	33,5	20	123	11,5	4.000	0,65
50701010	L-KK-10	10	21,5	10,6	57	40	24	139	13	6.300	0,89

**Lewis C-haak / gaffel / G80**  
**Lewis clevis C-hooks / G80**

| EN 1677-2  
| EN 1677-2



DK = diameter ketting  
DK = diameter chain

LC = lashing capaciteit  
LC = lashing capacity

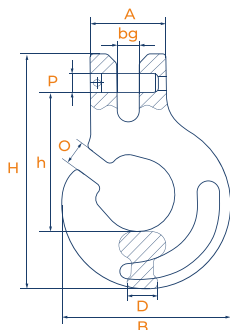

Artikelnr.	Type	DK	A	D	B	bg	H	h	O	P	LC	kg/stuk
Part no.		mm	mm	mm	mm	mm	mm	mm	mm	mm	kg	kg/piece
50721008	L-CH-7/8	7/8	35	18	72,7	9,5	95,5	59	9,8	9	4.000	0,37
50721010	L-CH-10	10	44	22	97	13	137	74	13	11,8	6.300	0,90

**Lewis glijhaak / G80**

| EN 1677-2

**Lewis glijding choker hook / G80**

| EN 1677-2



WLL = veilige belasting (4:1)  
WLL = working load limit (4:1)

Artikelnr.	Type	A	D	B	E	L	WLL	kg/stuk
Part no.		mm	mm	mm	mm	mm	kg	kg/piece
50740016	L-G-1.6T	50	17	71	18	132	1.600	0,68
50740020	L-G-2.0T	63,5	22	79	20	151,3	2.000	1,21

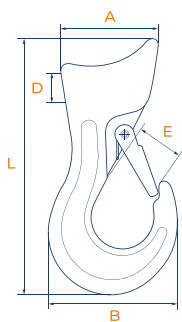

**Lewis aanlashaak / G80**

**Lewis weld-on hook / G80**



WLL = veilige belasting (4:1)  
WLL = working load limit (4:1)

Artikelnr.	Type	B	C	H	L	M	O	WLL	kg/stuk
Part no.		mm	mm	mm	mm	mm	mm	kg	kg/piece
50741001	L-AH-6	25	59,5	76	97	19	25	1.120	0,48
50741002	L-AH-8	34	67	92	114	23,3	26,5	2.000	0,85
50741003	L-AH-10	36	75	106	129	33,6	30,5	3.000	1,12
50741005	L-AH-13	45	94	136	171	44	34,5	5.000	2,50
50741008	L-AH-16	51	94	140	177	44	34,5	8.000	3,2
50741010	L-AH-18	53	135	175	223	54,7	51	10.000	5,2

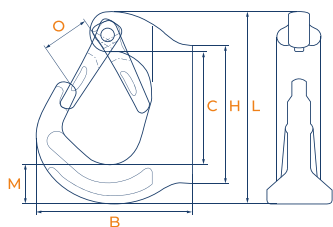



**Lewis hoogwaardig stalen S-haak / gesloten / G80**  
**Lewis high tensile S-hook / closed / G80**



WLL = veilige belasting (4:1)  
WLL = working load limit (4:1)

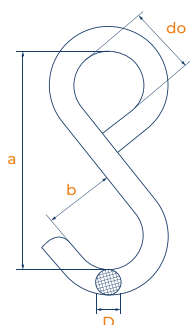

Artikelnr.	D	a	b	do	WLL	kg/stuk
Part no.	mm	mm	mm	mm	kg	kg/piece
39352010	10	80	25	25	200	0,10
39352013	13	100	30	30	300	0,20
39352016	16	130	40	40	500	0,50
39352020	20	180	55	55	1000	1,0

**Lewis hoogwaardig stalen S-haak / open / G80**  
**Lewis high tensile S-hook / open / G80**



WLL = veilige belasting (4:1)  
WLL = working load limit (4:1)

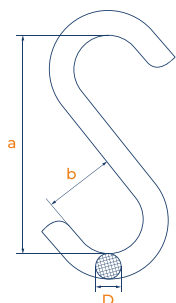

Artikelnr.	D	a	b	WLL	kg/stuk
Part no.	mm	mm	mm	kg	kg/piece
39351810	10	80	25	200	0,10
39351813	13	100	30	300	0,20
39351816	16	130	40	500	0,50
39351820	20	180	55	1000	1,00

**Lewis palset voor self-locking haak / G80/100**

**Lewis locking device for self-locking hook / G80/100**

| Inhoud set: pal, veer en stift

| Set contains: locking devise, spring and pin

DK = diameter ketting  
DK = diameter chain



Artikelnr.	Type	Voor type	DK	kg/stuk
Part no.		For type	mm	kg/piece
50953006	L-PS-6	L-SG-6 / L-SGC-6	6	0,03
50953008	L-PS-7/8	L-SG-7/8 / L-SGC-7/8	7/8	0,04
50953010	L-PS-10	L-SG-10 / L-SGC-10	10	0,06
50953013	L-PS-13	L-SG-13 / L-SGC-13	13	0,10
50953016	L-PS-16	L-SG-16 / L-SGC-16	16	0,14

**Lewis reserveset voor verbindingschalm / G80**

**Lewis spare set for connecting link / G80**

| Inhoud set: pin en bus

| Set contains: pin and bush

DK = diameter ketting  
DK = diameter chain



Artikelnr.	Type	Voor type	DK	kg/stuk
Part no.		For type	mm	kg/piece
50952006	L-PB-6	L-VS-6	6	0,03
50952008	L-PB-7/8	L-VS-7/8	7/8	0,035
50952010	L-PB-10	L-VS-10	10	0,06
50952013	L-PB-13	L-VS-13	13	0,1
50952016	L-PB-16	L-VS-16	16	0,135

**Lewis gesmede klepset voor gaffel- of ooghaak / G80**  
**Lewis forged latch set for sling hook / G80**

| Inhoud set: klep, veer en stift  
| Set contains: latch, spring and pin



DK = diameter ketting  
DK = diameter chain

Artikelnr.	Type	Voor type	DK	kg/stuk
Part no.		For type	mm	kg/piece
50951006	L-KS-6	L-GH-6 & L-OH-6	6	0,03
50951008	L-KS-7/8	L-GH-7/8 & L-OH-7/8	7/8	0,035
50951010	L-KS-10	L-GH-10 & L-OH-10	10	0,06
50951013	L-KS-13	L-GH-13 & L-OH-13	13	0,1
50951016	L-KS-16	L-GH-16 & L-OH-16	16	0,135



**Identificatieplaatje / G80**  
**Identification tag / G80**



Artikelnr.	Type	Voor type	kg/stuk
Part no.		For type	kg/piece
50955010	zonder ring / without ring	leng / 1 leg	0,12
50955020	zonder ring / without ring	2-3-4 sprong / 2-3-4 legs	0,12
50955030	met ring / with ring	leng / 1 leg	0,15
50955040	met ring / with ring	2-3-4 sprong / 2-3-4 legs	0,15
50955050	losse ring / ring only		0,03



**Lewis gesmede klepset voor Lewis aanlashaak / G80**  
**Lewis forged latch set for Lewis weld-on hook / G80**

| Inhoud set: klep, veer en stiften  
| Set contains: latch, spring and pins



Artikelnr.	Type	Voor type	kg/stuk
Part no.		For type	kg/piece
50951401	L-KA-6	L-AH-6	0,04
50951402	L-KA-8	L-AH-8	0,09
50951403	L-KA-10	L-AH-10	0,14
50951405	L-KA-13	L-AH-13	0,33
50951408	L-KA-16	L-AH-16	0,33
50951410	L-KA-18	L-AH-18	0,56

**Lewis borgpenset voor Lewis inkorthaak / G80**  
**Lewis safety device set for Lewis grab hook / G80**

| Inhoud set: pin, veer en borgdop  
| Set contains: pin, spring and button

DK = diameter ketting  
DK = diameter chain



Artikelnr.	Type	Voor type	DK	kg/stuk
Part no.		For type	mm	kg/piece
50954006	L-BG-6	L-IV-6	6	0,01
50954008	L-BG-7/8	L-IV-7/8	7/8	0,02
50954010	L-BG-10	L-IV-10	10	0,025
50954013	L-BG-13	L-IV-13	13	0,03
50954016	L-BG-16	L-IV-16	16	0,04



LEWIS  
HIJSMATERIAAL G100

LEWIS  
LIFTING GEAR G100



**Lewis hijsketting / G100 / blauw gelakt**  
**Lewis lifting chain / G100 / blue painted**

| EN 818-2  
| EN 818-2



DK = diameter ketting  
DK = diameter chain

WLL = veilige belasting (4:1)  
WLL = working load limit (4:1)

Artikelnr.	DK	B	b	l	WLL	kg/100m
Part no.	mm	mm	mm	mm	kg	kg/100m
52101006	6	22,2	7,8	18	1.400	80
52101008	8	29,6	10,4	24	2.500	151
52101010	10	37,0	13,0	30	4.000	240
52101013	13	48,1	16,9	39	6.700	400
52101016	16	59,2	20,8	48	10.000	600

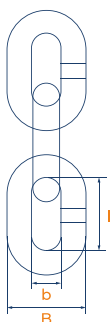

**Lewis verbindingschalm / G100**  
**Lewis connecting link / G100**

| EN 1677-1  
| EN 1677-1



DK = diameter ketting  
DK = diameter chain

WLL = veilige belasting (4:1)  
WLL = working load limit (4:1)

Artikelnr.	Type	DK	D	PxL	H	h	l	O	WLL	kg/stuk
Part no.		mm	mm	mm	mm	mm	mm	mm	kg	kg/piece
52301006	L-VSC-6	6	7	5,1 x 39,6	8,5	44,5	15	14	1.400	0,08
52301008	L-VSC-8	8	10	6,2 x 53,5	10,5	63	22,5	18,5	2.500	0,18
52301010	L-VSC-10	10	12,6	8,0 x 66,8	12,6	71	25,2	23	4.000	0,34
52301013	L-VSC-13	13	16,5	10,2 x 80	16,5	92,5	29,8	28	6.700	0,68
52301016	L-VSC-16	16	20	12,5 x 100	20	106,5	39,8	33,5	10.000	1,22

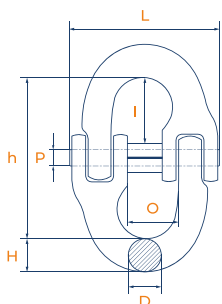

**Lewis topschalm / 1/2-sprong / G100**  
**Lewis masterlink / 1/2 legs / G100**

| EN 1677-4  
| EN 1677-4

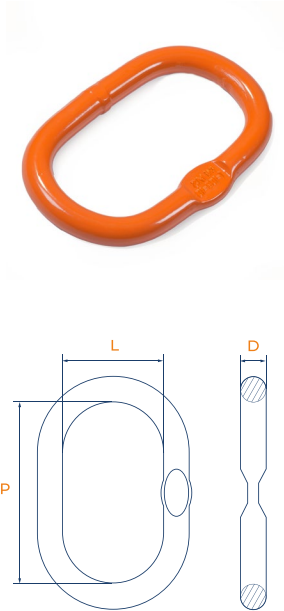

DK-1 = diameter ketting bij kettingleng  
DK-1 = diameter chain 1-leg

DK-2 = diameter ketting bij 2-sprong  
DK-2 = diameter chain 2-legs

WLL = veilige belasting (4:1)  
WLL = working load limit (4:1)

Artikelnr.	Type	DK-1	DK-2	D	L	P	WLL	kg/stuk
Part no.		mm	mm	mm	mm	mm	kg	kg/piece
52341007	L-76-10	6/7	6	13	60	110	2.300	0,34
52341008	L-87-10	8	7	16	60	110	3.500	0,53
52341010	L-108-10	10	8	18	75	135	5.000	0,86
52341013	L-1310-10	13	10	22	90	160	7.600	1,6
52341016	L-1613-10	16	13	27	100	180	10.000	2,46
52341019	L-1916-10	19	16	33	110	200	14.000	4,14

**Lewis topschalm / 3/4-sprong / G100**  
**Lewis masterlink / 3/4 legs / G100**

| EN 1677-4  
| EN 1677-4

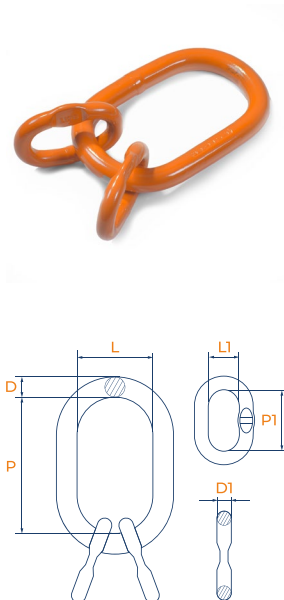

DK = diameter ketting  
DK = diameter chain

WLL = veilige belasting (4:1)  
WLL = working load limit (4:1)

Artikelnr.	Type	DK	D	D1	L	L1	P	P1	WLL	kg/stuk
Part no.		mm	mm	mm	mm	mm	mm	mm	kg	kg/piece
52342006	L-6-10	6	18	14	75	25	135	54	3.000	1,26
52342008	L-8-10	8	22	16	90	34	160	70	5.300	2,19
52342010	L-10-10	10	27	18	100	40	180	85	8.400	3,60
52342013	L-13-10	13	33	22	110	50	200	115	14.000	6,35
52342016	L-16-10	16	36	28	140	65	260	140	21.200	9,98



**Lewis topschalm / inkorthaak / leng / G100**

| EN 1677-4

**Lewis masterlink / shortening hook / 1 leg / G100**

| EN 1677-4



DK = diameter ketting  
DK = diameter chain

WLL = veilige belasting (4:1)  
WLL = working load limit (4:1)

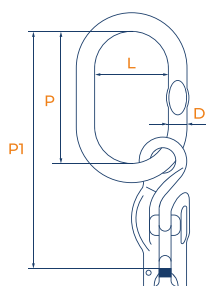

Artikelnr.	Type	DK	D	L	P	P1	WLL	kg/stuk
Part no.		mm	mm	mm	mm	mm	kg	kg/piece
5234821006	L-TIC-1-6	6	13	60	110	198	1.400	0,64
5234821008	L-TIC-1-8	8	14	70	120	236	2.500	1,31
5234821010	L-TIC-1-10	10	17	80	140	285	4.000	2,05
5234821013	L-TIC-1-13	13	22	95	160	338	6.700	3,84
5234821016	L-TIC-1-16	16	25	110	190	406	10.000	6,75

**Lewis topschalm / inkorthaak / 2-sprong / G100**

| EN 1677-4

**Lewis masterlink / shortening hook / 2 legs / G100**

| EN 1677-4



DK = diameter ketting  
DK = diameter chain

WLL = veilige belasting (4:1)  
WLL = working load limit (4:1)

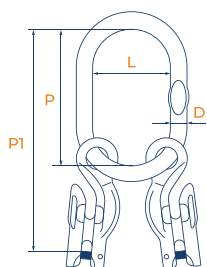

Artikelnr.	Type	DK	D	L	P	P1	WLL	kg/stuk
Part no.		mm	mm	mm	mm	mm	kg	kg/piece
5234822006	L-TIC-2-6	6	14	70	120	208	2.000	1,04
5234822008	L-TIC-2-8	8	17	80	140	256	3.550	2,30
5234822010	L-TIC-2-10	10	22	95	160	305	5.600	4,08
5234822013	L-TIC-2-13	13	25	110	190	368	9.500	6,97
5234822016	L-TIC-2-16	16	32	130	230	446	14.000	13,47

**Lewis topschalm / inkorthaak / 3/4-sprong / G100** | EN 1677-4  
**Lewis masterlink / shortening hook / 3/4 legs / G100** | EN 1677-4



DK = diameter ketting  
 DK = diameter chain

WLL = veilige belasting (4:1)  
 WLL = working load limit (4:1)

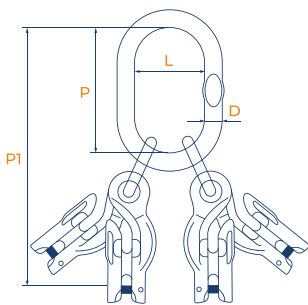

Artikelnr.	Type	DK	D	L	P	P1	WLL	kg/stuk
Part no.		mm	mm	mm	mm	mm	kg	kg/piece
5234823006	L-TIC-4-6	6	18	75	135	277	3.000	2,32
5234823008	L-TIC-4-8	8	22	90	160	346	5.300	4,95
5234823010	L-TIC-4-10	10	27	100	180	410	8.000	8,80
5234823013	L-TIC-4-13	13	33	110	200	493	14.000	15,80
5234823016	L-TIC-4-16	16	36	140	260	616	21.200	28,60

**Lewis ooghaak / gesmede veiligheidsklep / G100** | EN 1677-2  
**Lewis eye sling hook / forged safety latch / G100** | EN 1677-2



DK = diameter ketting  
 DK = diameter chain

WLL = veilige belasting (4:1)  
 WLL = working load limit (4:1)

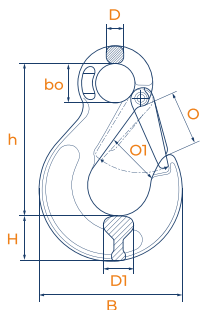

Artikelnr.	Type	DK	D	D1	B	H	h	O	O1	bo	WLL	kg/stuk
Part no.		mm	mm	mm	mm	mm	mm	mm	mm	mm	kg	kg/piece
52402006	L-OHC-6	6	10	16,5	68	21	80	25	18,5	20,5	1.400	0,32
52402008	L-OHC-8	8	11	17	87	27	99	28	25	25	2.500	0,6
52402010	L-OHC-10	10	16	24	105	33	106	35	29,5	32	4.000	1,2
52402013	L-OHC-13	13	19	33	138	43,5	156	43	38	43	6.700	2,2
52402016	L-OHC-16	16	24	40	158	50	185	51	46	51	10.000	3,5

**Lewis gaffelhaak / gesmede veiligheidssleutel / G100**  
**Lewis clevis sling hook / forged safety latch / G100**

| EN 1677-2  
| EN 1677-2



DK = diameter ketting  
DK = diameter chain

WLL = veilige belasting (4:1)  
WLL = working load limit (4:1)

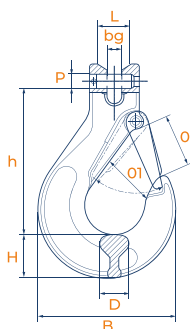

Artikelnr.	Type	DK	D	PxL	B	bg	H	h	O	O1	WLL	kg/stuk
Part no.		mm	mm	mm	mm	mm	mm	mm	mm	mm	kg	kg/piece
52401006	L-GHC-6	6	16,5	7,6 x 30	68,5	7,5	21	73	25	17	1.400	0,33
52401008	L-GHC-8	8	17	9,8 x 34	88	9,5	27,5	88,5	30,5	23	2.500	0,6
52401010	L-GHC-10	10	24	13 x 46	102	12,5	32	105	37,8	29	4.000	1,3
52401013	L-GHC-13	13	34	15,8 x 57	134	15	42	132	48,6	38	6.700	2,3
52401016	L-GHC-16	16	38	19,5 x 68	160,5	18,5	50	161	54	46	10.000	3,6

**Lewis self-locking haken / gaffel / G100**  
**Lewis clevis self-locking hook / G100**

| EN 1677-3  
| EN 1677-3



DK = diameter ketting  
DK = diameter chain

WLL = veilige belasting (4:1)  
WLL = working load limit (4:1)

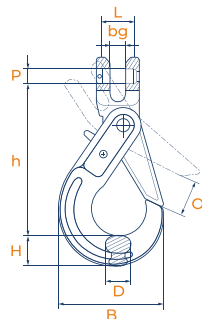

Artikelnr.	Type	DK	D	PxL	B	bg	H	h	O	WLL	kg/stuk
Part no.		mm	mm	mm	mm	mm	mm	mm	mm	kg	kg/piece
52601006	L-SGC-6	6	15	7,6x30	73	8	19,5	96	31,5	1.400	0,5
52601008	L-SGC-8	8	20	9,8x34	90	9,5	25,5	121	40	2.500	0,9
52601010	L-SGC-10	10	26	13x44	108	12	29,5	144	46	4.000	1,4
52601013	L-SGC-13	13	32,5	15,8x57	137	15	39,5	182	66	6.700	2,9
52601016	L-SGC-16	16	38	19,5x68	168	18,5	50	220	75	10.000	5,5

**Lewis inkortklaus / gaffel / beveiliging / G100**  
**Lewis clevis shortening clutch / safety pawl / G100**

| EN 1677-1  
| EN 1677-1



DK = diameter ketting  
DK = diameter chain

WLL = veilige belasting (4:1)  
WLL = working load limit (4:1)

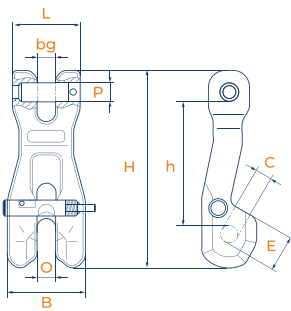

Artikelnr.	Type	DK	B	bg	C	H	L	O	P	WLL	kg/stuk
Part no.		mm	mm	mm	mm	mm	mm	mm	mm	kg	kg/piece
52503406	L-KVC-6	6	38	7,5	7,5	73	27	7,5	7,5	1.400	0,25
52503408	L-KVC-8	8	50	9,5	9,2	82	33	9,5	9	2.500	0,41
52503410	L-KVC-10	10	69	11,7	12	115	43,5	11,7	13	4.000	0,80
52503413	L-KVC-13	13	79	15	15,5	149	55	15	16	6.700	1,67
52503416	L-KVC-16	16	98	19	18,5	184	70	19	19,5	10.000	4,20

**Lewis inkorthaak / gaffel / G100**  
**Lewis clevis grab hook / G100**

| EN 1677-1  
| EN 1677-1



DK = diameter ketting  
DK = diameter chain

WLL = veilige belasting (4:1)  
WLL = working load limit (4:1)

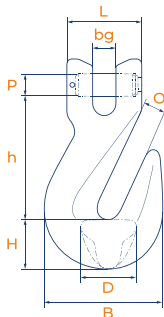

Artikelnr.	Type	DK	D	PxL	B	bg	H	h	O	WLL	kg/stuk
Part no.		mm	mm	mm	mm	mm	mm	mm	mm	kg	kg/piece
52501006	L-IGC-6	6	25,5	7,6x30	46,5	7,5	18	44,5	8	1.400	0,22
52501008	L-IGC-8	8	38,5	9,8x34	54	9,5	22	53	11	2.500	0,34
52501010	L-IGC-10	10	42	13x44	72	12,5	31	73	13,5	4.000	0,82
52501013	L-IGC-13	13	53,5	15,8x57	96	15	45,5	92	15	6.700	1,75
52501016	L-IGC-16	16	74	19,5x68	115	18,5	48,4	103	19	10.000	2,88

**Lewis hijsbandhaak / pin / veiligheidsklep / G100**  
**Lewis webbing sling hook / safety latch / G100**

| EN 1677-2  
| EN 1677-2



WLL = veilige belasting (4:1)  
WLL = working load limit (4:1)

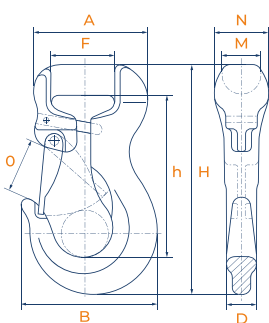

Artikelnr.	Type	A	D	B	F	H	h	M	N	O	WLL	kg/stuk
Part no.		mm	mm	mm	mm	mm	mm	mm	mm	mm	kg	kg/piece
52661001	L-HHC-1	57	17	73	35	117	84	18	28	24	1.000	0,45
52661002	L-HHC-2	72	18	86	40	143	102	24	34	28	2.000	0,90
52661003	L-HHC-3	87	24	108	47	168,5	120	29	38	30	3.000	1,48
52661005	L-HHC-5	131	28	131	73	224	155	35	45	43	5.000	3,40

**Lewis palset voor self-locking haak / G80/100**  
**Lewis locking device for self-locking hook / G80/100**

| Inhoud set: pal, veer en stift  
| Set contains: locking devise, spring and pin



DK = diameter ketting  
DK = diameter chain



Artikelnr.	Type	Voor type	DK	kg/stuk
Part no.		For type	mm	kg/piece
50953006	L-PS-6	L-SG-6 / L-SGC-6	6	0,03
50953008	L-PS-7/8	L-SG-7/8 / L-SGC-7/8	7/8	0,04
50953010	L-PS-10	L-SG-10 / L-SGC-10	10	0,06
50953013	L-PS-13	L-SG-13 / L-SGC-13	13	0,10
50953016	L-PS-16	L-SG-16 / L-SGC-16	16	0,14

**Lewis reserveset voor verbindingsschalm / G100**  
**Lewis spare set for connecting link / G100**

| EN 1677-1 / Inhoud set: pin en bus  
| EN 1677-1 / Set contains: pin and bush

DK = diameter ketting  
DK = diameter chain



Artikelnr.	Type	Voor type	DK	kg/stuk
Part no.		For type	mm	kg/piece
52952006	L-PBC-6	L-VSC-6	6	0,03
52952008	L-PBC-8	L-VSC-8	8	0,035
52952010	L-PBC-10	L-VSC-10	10	0,06
52952013	L-PBC-13	L-VSC-13	13	0,10
52952016	L-PBC-16	L-VSC-16	16	0,135

**Lewis gesmede klepset voor gaffel/ooghaak / G100**  
**Lewis forged latch set for sling hook / G100**

| EN 1677-1  
| EN 1677-1

DK = diameter ketting  
DK = diameter chain



Artikelnr.	Type	Voor type	DK	kg/stuk
Part no.		For type	mm	kg/piece
52951006	L-KSC-6	L-GHC-6 & L-OHC-6	6	0,03
52951008	L-KSC-8	L-GHC-8 & L-OHC-8	8	0,035
52951010	L-KSC-10	L-GHC-10 & L-OHC-10	10	0,06
52951013	L-KSC-13	L-GHC-13 & L-OHC-13	13	0,10
52951016	L-KSC-16	L-GHC-16 & L-OHC-16	16	0,135

**Identificatieplaatje / G100**  
**Identification tag / G100**

Artikelnr.	Type	Voor type	kg/stuk
Part no.		For type	kg/piece
52955210	zonder ring / without ring	leng / 1 leg	0,12
52955220	zonder ring / without ring	2-3-4 sprong / 2-3-4 legs	0,12
52955230	met ring / with ring	leng / 1 leg	0,15
52955240	met ring / with ring	2-3-4 sprong / 2-3-4 legs	0,15

LEWIS  
HIJSOGEN

LEWIS  
LIFTING POINTS





## Lewis hoogwaardig stalen oogbout / G80

### Lewis high tensile eyebolt / G80



WLL1 = working load limit kettingleng 0°  
WLL1 = working load limit 1-leg 0°

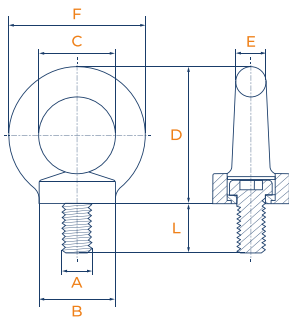

Artikelnr.	A	D	B	C	E	F	L	WLL1	kg/stuk
Part no.	mm	mm	mm	mm	mm	mm	mm	kg (0°)	kg/piece
50801006	M-6	29	17	16	6	28	13	400	0,03
50801008	M-8	36	20	20	8	36	15	800	0,06
50801010	M-10	45	25	25	10	45	18	1.000	0,11
50801012	M-12	53	30	30	12	54	22	2.000	0,18
50801014	M-14	61,5	35	35	14	63	28	3.000	0,28
50801016	M-16	62	35	35	14	63	28	4.000	0,3
50801018	M-18	71	40	40	16	72	30	5.000	0,42
50801020	M-20	71	40	40	16	72	30	6.000	0,45
50801024	M-24	90	50	50	20	90	38	8.000	0,95
50801027	M-27	90	50	50	20	90	38	10.000	0,88
50801030	M-30	109	65	60	24	108	45	12.000	1,76
50801036	M-36	128	75	70	28	126	55	16.000	2,65
50801042	M-42	147	85	80	32	144	65	24.000	4,06
50801048	M-48	168	100	90	38	166	70	32.000	6,38
50801056	M-56	187	110	100	42	184	80	40.000	8,80
50801064	M-64	203	120	110	48	206	90	50.000	12,4

**Lewis hoogwaardig stalen oogmoer / G80**  
**Lewis high tensile eyenut / G80**

WLL1 = working load limit kettingleng 0°

WLL1 = working load limit 1-leg 0°

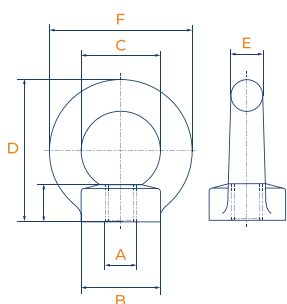

Artikelnr.	A	D	B	C	E	F	WLL1	kg/stuk
Part no.	mm	mm	mm	mm	mm	mm	kg (0°)	kg/piece
50802006	M-6	36	17	20	8	36	400	0,049
50802008	M-8	36	20	20	8	36	800	0,05
50802010	M-10	45	25	25	10	45	1.000	0,09
50802012	M-12	53	30	30	12	54	2.000	0,16
50802014	M-14	62	35	35	14	63	3.000	0,24
50802016	M-16	62	35	36	14	63	4.000	0,24
50802018	M-18	71	40	40	16	72	5.000	0,36
50802020	M-20	71	40	40	16	72	6.000	0,36
50802024	M-24	90	50	50	20	90	8.000	0,69
50802027	M-27	90	50	50	20	90	10.000	0,7
50802030	M-30	109	65	60	24	108	12.000	1,3

**Lewis hoogwaardig stalen oogbout / G80**  
**Lewis high tensile eyebolt / G80**

| Draaibaar / gelagerd  
| Rotating / ball bearing



WLL1 = working load limit kettingleng 0°  
WLL1 = working load limit 1-leg 0°

WLL2 = working load limit kettingleng 90°  
WLL2 = working load limit 1-leg 90°

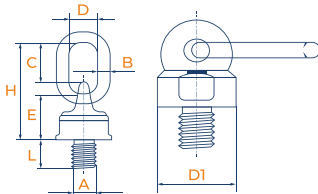

Artikelnr.	A	D	D1	B	C	E	H	L	WLL1	WLL2	kg/stuk
Part no.	mm	mm	mm	mm	mm	mm	mm	mm	kg (0°)	kg (90°)	kg/piece
50806008	M-8	30	36	14	45	27	96	13	600	300	0,45
50806010	M-10	30	36	14	45	27	96	18	1.000	500	0,45
50806012	M-12	30	36	14	45	27	96	18	1.000	500	0,46
50806014	M-14	30	36	14	45	27	96	20	2.000	1.120	0,45
50806016	M-16	30	36	14	45	28	97	20	2.000	1.120	0,46
50806020	M-20	35	50	16	58	40	126	30	4.000	2.000	0,96
50806024	M-24	30	57	18	63	48	151	30	6.300	3.150	1,45
50806027	M-27	40	57	20	63	48	151	35	6.300	3.150	1,47
50806030	M-30	40	66	20	69	61	166	35	10.600	5.300	2,17
50806036	M-36	50	80	22	96	68	205	53	11.800	8.000	4,17
50806042	M-42	50	80	25	96	68	205	63	15.000	10.000	6,72

**Lewis aanlasoog / G80**  
**Lewis weld-on ring / G80**

| Zonder veer  
| Without spring



WLL = veilige belasting (4:1)  
WLL = working load limit (4:1)

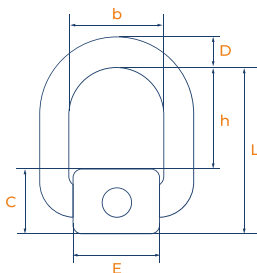

Artikelnr.	Type	D	b	C	E	h	L	WLL	kg/stuk
Part no.		mm	mm	mm	mm	mm	mm	kg	kg/piece
50761001	ASPK-01	13	41	35	37	37	65,5	1.120	0,4
50761002	ASPK-02	14	42	37	40	48	74	2.000	0,5
507610032	ASPK-032	18	45	40	42,5	46	77	3.150	0,7
50761005	ASPK-05	22	55	52	61	53	96	5.300	1,5
50761008	ASPK-08	26	70	57	70	67	114,5	8.000	2,5
50761015	ASPK-15	34	97	77	90	92	154	15.000	5,9

LEWIS  
RIGGING MATERIAAL

LEWIS  
RIGGING GEAR



**Lewis hoogwaardige harpsluiting / moerbout**  
**Lewis high tensile bow shackle / safety pin**

| Gelijkend US Fed. Spec. RR-C-271

| Generally according to US Fed. Spec. RR-C-271

WLL = veilige belasting (6:1)  
WLL = working load limit (6:1)

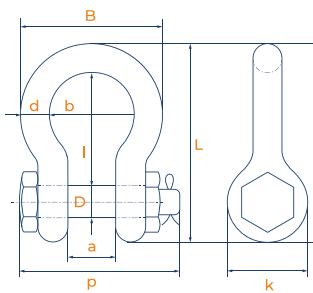

Artikelnr.	WLL	D	d	a	B	b	p	L	l	k	kg/stuk
Part no.	ton	mm	mm	mm	mm	mm	mm	mm	mm	mm	kg/piece
541020005	0,5	8	7	12	33	20	38	48	29	17	0,07
5410200075	0,75	10	9	13	38	21	43	54	31	21	0,13
54102001	1	11	10	17	46	26	52	65	36	25	0,17
541020015	1,5	12	11	18	51	29	58	74	43	27	0,25
54102002	2	16	13	21	58	32	67	83	48	30	0,44
5410200325	3,25	19	16	27	75	43	85	106	60	39	0,79
5410200475	4,75	22	19	32	89	50	100	125	71	47	1,26
541020065	6,5	25	22	38	102	58	120	148	84	53	1,9
541020085	8,5	28	25	44	118	68	137	165	95	59	2,8
541020095	9,5	32	29	49	132	74	155	188	108	68	3,9
54102012	12	35	32	51	147	83	163	208	121	75	5,3
541020135	13,5	38	35	57	162	92	180	230	132	82	6,95
54102017	17	42	38	63	174	98	193	246	145	91	8,85
54102025	25	50	45	74	216	126	220	298	178	104	15
54102035	35	56	52	84	252	145	250	338	197	122	19,5
54102055	55	70	67	107	318	180	310	443	260	145	39

**Lewis hoogwaardige harpsluiting / borstbout**  
**Lewis high tensile bow shackle / screw collar pin**

| Gelijkend US Fed. Spec. RR-C-271  
| Generally according to US Fed. Spec. RR-C-271

WLL = veilige belasting (6:1)  
WLL = working load limit (6:1)

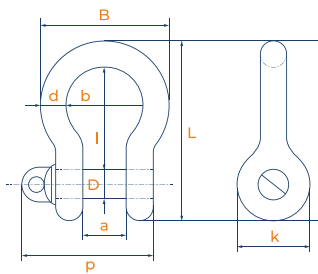

Artikelnr.	WLL	D	d	a	B	b	p	L	l	k	kg/stuk
Part no.	ton	mm	mm	mm	mm	mm	mm	mm	mm	mm	kg/piece
5410100033	0,33	6	5	10	26	15	30	38	22	15	0,02
541010005	0,5	8	7	12	33	20	38	48	29	17	0,07
5410100075	0,75	10	9	13	38	21	43	54	31	21	0,13
54101001	1	11	10	17	46	26	52	65	36	25	0,17
541010015	1,5	12	11	18	51	29	58	74	43	27	0,25
54101002	2	16	13	21	58	32	67	83	48	30	0,44
5410100325	3,25	19	16	27	75	43	85	106	60	39	0,79
5410100475	4,75	22	19	32	89	50	100	125	71	47	1,26
541010065	6,5	25	22	38	102	58	120	148	84	53	1,58
541010085	8,5	28	25	44	118	68	137	165	95	59	2,3
541010095	9,5	32	29	49	132	74	155	188	108	68	3,1
54101012	12	35	32	51	147	83	163	208	121	75	4,35

**Lewis hoogwaardige D-sluiting / moerbout**  
**Lewis high tensile dee shackle / safety pin**

| Gelijkend US Fed. Spec. RR-C-271  
| Generally according to US Fed. Spec. RR-C-271

WLL = veilige belasting (6:1)  
WLL = working load limit (6:1)

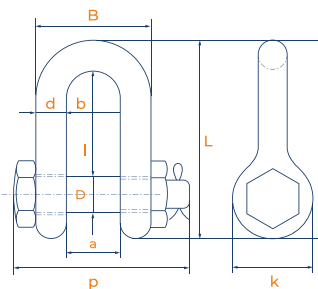

Artikelnr.	WLL	D	d	a	B	b	p	L	k	l	kg/stuk
Part no.	ton	mm	mm	mm	mm	mm	mm	mm	mm	mm	kg/piece
54202002	2	16	13	20	46	20	73	76	31	41	0,32
5420200325	3,25	19	17	26	59	26	94	97	40	50	0,63

**Lewis hoogwaardige D-sluiting / borstbout**  
**Lewis high tensile dee shackle / screw collar pin**

| Gelijkend US Fed. Spec. RR-C-271  
| Generally according to US Fed. Spec. RR-C-271

WLL = veilige belasting (6:1)  
WLL = working load limit (6:1)

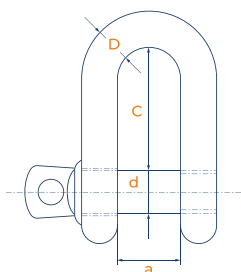

Artikelnr.	WLL	D	d	a	C	kg/stuk
Part no.	ton	mm	mm	mm	mm	kg/piece
5420100075	0,75	8	9	12	25	0,08
54201001	1	10	11	15	31	0,13
542010015	1,5	12	13	18	36	0,19
54201002	2	13	16	20	40	0,30
5420100325	3,25	17	19	25	51	0,59

**Lewis hoogwaardige harpsluiting / moerbout / zwart**  
**Lewis high tensile bow shackle / safety pin / black**

| Gelijkend US Fed. Spec. RR-C-271  
| Generally according to US Fed. Spec. RR-C-271

WLL = veilige belasting (6:1)  
WLL = working load limit (6:1)

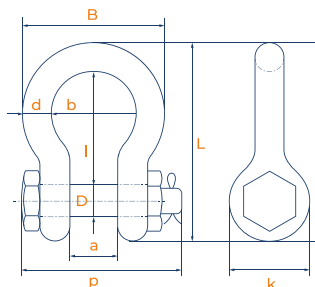

Artikelnr.	WLL	D	d	a	B	b	p	L	l	k	kg/stuk
Part no.	ton	mm	mm	mm	mm	mm	mm	mm	mm	mm	kg/piece
5410600325	3,25	19	16	27	75	43	85	106	60	39	0,79

**Lewis hoogwaardige harpsluiting / borstbout / zwart**  
**Lewis high tensile bow shackle / screw pin / black**

| Gelijkend US Fed. Spec. RR-C-271

| Generally according to US Fed. Spec. RR-C-271

WLL = veilige belasting (6:1)  
WLL = working load limit (6:1)

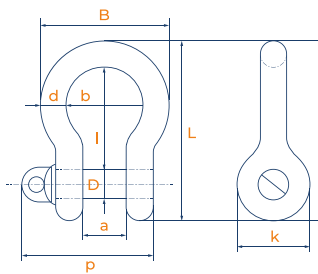

Artikelnr.	WLL	D	d	a	B	b	p	L	I	k	kg/stuk
Part no.	ton	mm	mm	mm	mm	mm	mm	mm	mm	mm	kg/piece
541040005	0,5	8	7	12	33	20	38	48	29	17	0,07
5410400075	0,75	10	9	13	38	21	43	54	31	21	0,13
54104001	1	11	10	17	46	26	52	65	36	25	0,17
541040015	1,5	12	11	18	51	29	58	74	43	27	0,25
54104002	2	16	13	21	58	32	67	83	48	30	0,44
5410400325	3,25	19	16	27	75	43	85	106	60	39	0,79



**Lewis hoogwaardig stalen spanschroef / oog-oog**  
**Lewis high tensile rigging screw / eye-eye**

| Gelijkend US Fed. Spec. FF-T-791b

| Generally according to US Fed. Spec. FF-T-791b

WLL = veilige belasting (5:1)  
 WLL = working load limit (5:1)

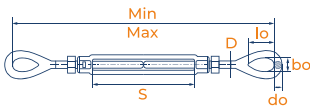

Artikelnr.	S	WLL	D	do	lo	bo	Min	Max	kg/stuk
Part no.	inch	ton	inch	mm	mm	mm	mm	mm	kg/piece
561010X06	6	0,55	3/8	9	28	13	290	440	0,34
561012X06	6	1	1/2	12	36	18	330	480	0,64
561012X09	9	1	1/2	12	36	18	405	630	0,76
561012X12	12	1	1/2	12	36	18	482	782	0,96
561016X06	6	1,6	5/8	14	44	22	375	525	1,18
561016X09	9	1,6	5/8	14	44	22	450	675	1,38
561016X12	12	1,6	5/8	14	44	22	526	826	1,76
561020X06	6	2,36	3/4	17	52	25	415	565	1,80
561020X09	9	2,36	3/4	17	52	25	490	715	2,17
561020X12	12	2,36	3/4	17	52	25	560	860	2,44
561020X18	18	2,36	3/4	17	52	25	720	1170	2,44
561022X12	12	3,27	7/8	20	59	31	592	885	3,38
561022X18	18	3,27	7/8	20	59	31	750	1200	4,42
561025X06	6	4,54	1	22	75	37	517	668	4,05
561025X12	12	4,54	1	22	75	37	656	943	5,25
561025X18	18	4,54	1	22	75	37	819	1269	6,25

**Lewis hoogwaardig stalen spanschroef / gaffel-gaffel**  
**Lewis high tensile rigging screw / jaw-jaw**

| Gelijkend US Fed. Spec. FF-T-791b

| Generally according to US Fed. Spec. FF-T-791b

WLL = veilige belasting (5:1)  
WLL = working load limit (5:1)

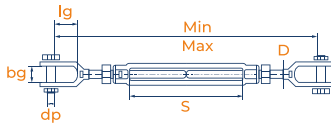

Artikelnr.	S	WLL	D	bg	Min	Max	lg	dp	kg/stuk
Part no.	inch	ton	inch	mm	mm	mm	mm	mm	kg/piece
563010X06	6	0,55	3/8	13	270	420	23	8	0,38
563012X06	6	1	1/2	17	305	455	30	9	0,71
563012X09	9	1	1/2	17	375	600	30	9	0,82
563012X12	12	1	1/2	17	450	750	30	9	0,98
563016X06	6	1,6	5/8	19	340	490	34	12	1,18
563016X09	9	1,6	5/8	19	425	650	34	12	1,44
563016X12	12	1,6	5/8	19	490	790	34	12	1,75
563020X06	6	2,36	3/4	23	375	525	41	15	1,78
563020X09	9	2,36	3/4	23	450	675	41	15	2,12
563020X12	12	2,36	3/4	23	530	830	41	15	2,59
563020X18	18	2,36	3/4	23	680	1130	41	15	3,25
563022X12	12	3,27	7/8	27	560	860	46	19	3,52
563022X18	18	3,27	7/8	27	715	1165	46	19	4,58
563025X06	6	4,54	1	30	445	595	54	22	4,18
563025X12	12	4,54	1	30	595	895	54	22	5,49
563025X18	18	4,54	1	30	760	1210	54	22	6,44
563032X12	12	6,90	1 1/4	44	668	962	77	28	10,34
563032X18	18	6,90	1 1/4	44	796	1248	77	28	12,31
563038X12	12	9,71	1 1/2	53	684	986	76	35	16,10
563038X24	24	9,71	1 1/2	53	1005	1600	76	35	21,59
563045X24	24	12,70	1 3/4	60	1051	1650	90	42	29,03
563050X24	24	16,80	2	69	1210	1820	120	50	42,75

**Lewis hoogwaardig stalen spanschroef / gaffel-oog**  
**Lewis high tensile rigging screw / jaw-eye**

| Gelijkend US Fed. Spec. FF-T-791b  
| Generally according to US Fed. Spec. FF-T-791b

WLL = veilige belasting (5:1)  
WLL = working load limit (5:1)

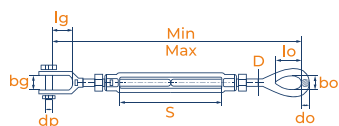

Artikelnr.	S	WLL	D	do	lo	bg	bo	Min	Max	lg	dp	kg/stuk
Part no.	inch	ton	inch	mm	mm	mm	mm	mm	mm	mm	mm	kg/piece
562010X06	6	0,55	3/8	9	28	13	13	279	429	23	8	0,36
562012X06	6	1	1/2	12	36	17	18	315	465	30	9	0,72
562012X09	9	1	1/2	12	36	17	18	390	615	30	9	0,84
562012X12	12	1	1/2	12	36	17	18	465	765	30	9	1,02
562016X06	6	1,6	5/8	14	44	19	22	360	510	34	12	1,2
562016X09	9	1,6	5/8	14	44	19	22	430	655	34	12	1,48
562016X12	12	1,6	5/8	14	44	19	22	515	815	34	12	1,76
562020X06	6	2,36	3/4	17	52	23	25	390	540	41	15	1,88
562020X09	9	2,36	3/4	17	52	23	25	460	685	41	15	2,25
562020X12	12	2,36	3/4	17	52	23	25	540	840	41	15	2,60
562020X18	18	2,36	3/4	17	52	23	25	695	1145	41	15	3,29
562022X12	12	3,27	7/8	20	59	27	31	570	870	46	19	3,56
562022X18	18	3,27	7/8	20	59	27	31	725	1175	46	19	4,62
562025X06	6	4,54	1	22	75	30	37	465	615	54	22	4,15
562025X12	12	4,54	1	22	75	30	37	620	920	54	22	5,31
562025X18	18	4,54	1	22	75	30	37	770	1220	54	22	6,35

LEWIS  
LADINGSPANNERS

LEWIS  
LOADBINDERS

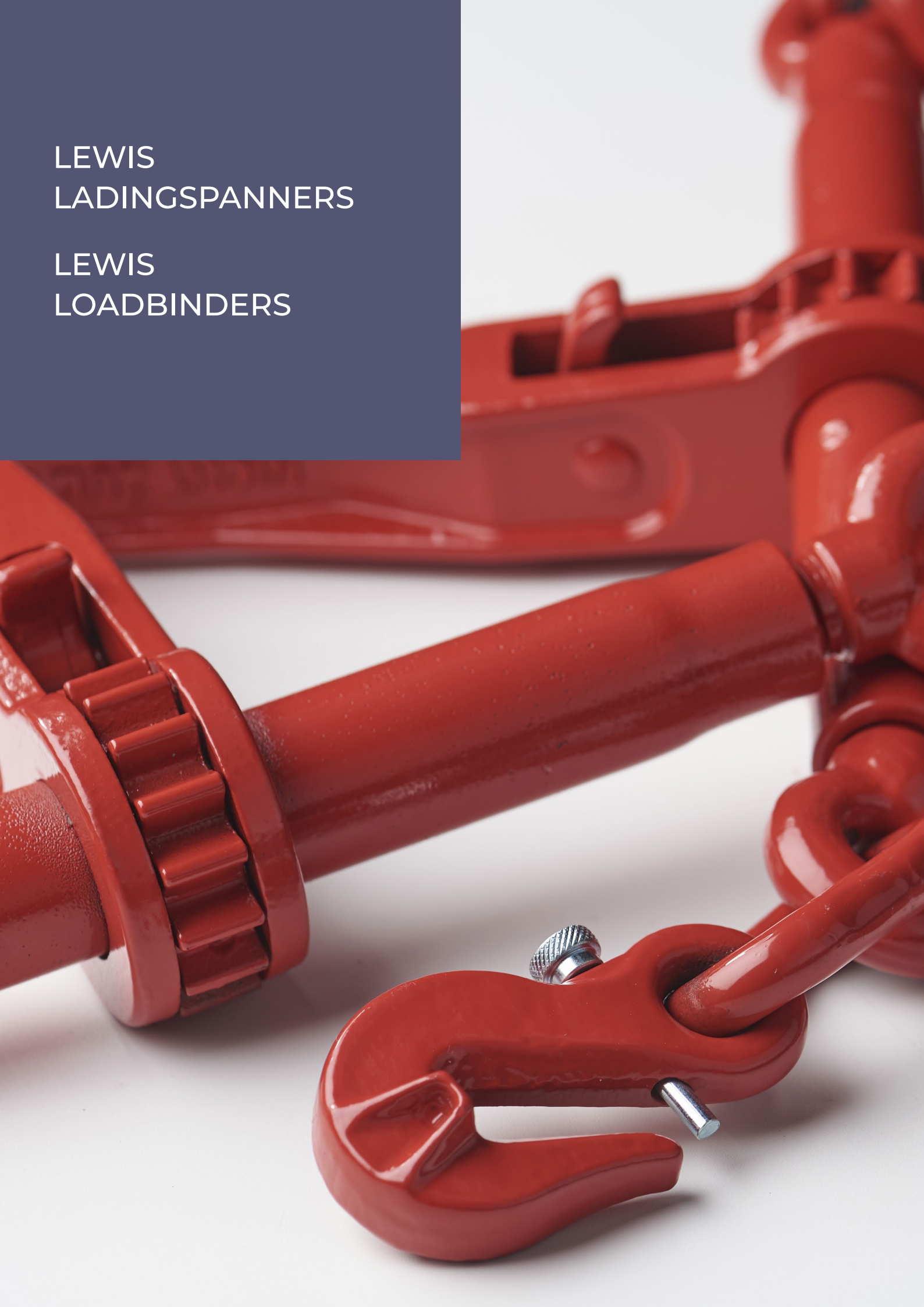

**Lewis ladingspanner / ratel / standaard / G70**  
**Lewis loadbinder with ratchet / standard / G70**

| met inkorthaken  
| with grab hooks



DK = diameter ketting  
DK = diameter chain

LC = lashing capaciteit  
LC = lashing capacity

mbl = minimum breekkracht  
mbl = minimum breaking load

Artikelnr.	Type	DK	D	L	I	Min	Max	LC	mbl	kg/stuk
Part no.		mm	mm	mm	mm	mm	mm	kg	kg	kg/piece
5020100810	L-LBS-810	8-10	65	390	255	570	760	2.450	8.620	4,5
5020101013	L-LBS-1013	10-13	65	390	255	580	780	4.175	15.000	5
5020101316	L-LBS-1316	13-16	65.	390.	260	670	860	5.900	20.800	7

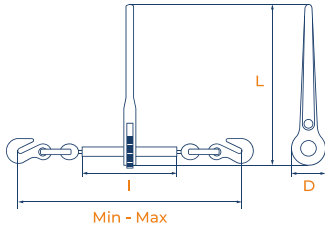

**Lewis ladingspanner / ratel / G80**  
**Lewis loadbinder with ratchet / G80**

| EN 12195-3 / met inkorthaken  
| EN 12195-3 / with grab hooks



DK = diameter ketting  
DK = diameter chain

LC = lashing capaciteit  
LC = lashing capacity

mbl = minimum breekkracht  
mbl = minimum breaking load

Artikelnr.	Type	DK	D	L	I	Min	Max	LC	mbl	kg/stuk
Part no.		mm	mm	mm	mm	mm	mm	kg	kg	kg/piece
50202006	L-LBV-6	6	43	230	170	410	520	2.240	4.480	3
50202008	L-LBV-8	8	65	390	255	590	750	4.000	8.000	5
50202010	L-LBV-10	10	65	390	255	610	800	6.300	12.600	5,5
50202013	L-LBV-13	13	65.	390.	260	700	850	10.600	21.200	7,5
50202016	L-LBV-16	16	65.	390.	260	730	880	16.100	32.200	10,0

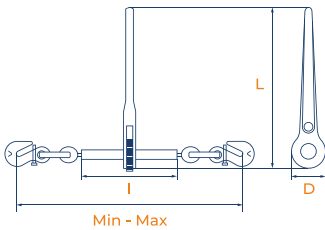

**Lewis ladingspanner / ratel / G100**  
**Lewis loadbinder with ratchet / G100**

| EN 12195-3 / met inkorthaken  
| EN 12195-3 / with grab hooks



DK = diameter ketting  
DK = diameter chain

LC = lashing capaciteit  
LC = lashing capacity

mbl = minimum breekkracht  
mbl = minimum breaking load

Artikelnr.	Type	DK	D	L	I	Min	Max	LC	mbl	kg/stuk
Part no.		mm	mm	mm	mm	mm	mm	kg	kg	kg/piece
52202008	L-LBVC-8	8	65	371	255	580	750	5.000	10.000	4,5
52202010	L-LBVC-10	10	65	371	255	610	780	8.000	16.000	5,55
52202013	L-LBVC-13	13	65.	371.	260	700	870	13.400	26.800	8,05

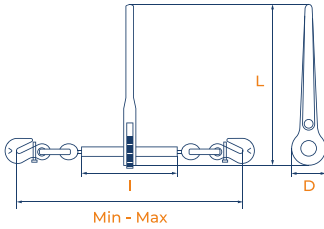

**Lewis QuickBinder / uitvalbeveiliging / G80**  
**Lewis Quickbinder / safety device / G80**

| EN 12195-3 / met inkorthaken  
| EN 12195-3 / with grab hooks



DK = diameter ketting  
DK = diameter chain

LC = lashing capaciteit  
LC = lashing capacity

mbl = minimum breekkracht  
mbl = minimum breaking load

Artikelnr.	Type	DK	D	L	I	Min	Max	LC	mbl	kg/stuk
Part no.		mm	mm	mm	mm	mm	mm	kg	kg	kg/piece
50221008	L-QB-8	8	65	360	250	590	750	4.000	8.000	4,5
50221010	L-QB-10	10	65	360	250	600	790	6.300	12.600	5,5
50221013	L-QB-13	13	65	360	260	700	850	10.600	21.200	7
50221210	L-QBZ-10	10	65.	360.	250	340	520	6.300	12.600	3,5
50261210	L-QBZC-10 (G100)	10	65.	360.	250	340	520	10.000	20.000	3,5

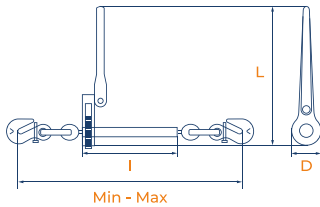

**Identificatieplaatje / lashing**  
**Identification tag / lashing**

Artikelnr.	Type	kg/stuk
Part no.		kg/piece
50955410	zonder ring / without ring	0,12
50955420	met ring / with ring	0,15



LEWIS  
TAKELS

LEWIS  
HOISTS





## Lewis handkettingtakel Lewis chain block

| Standaard hijshoogte 3 meter  
| Standard lift 3 metres



WLL = veilige belasting (4:1)  
WLL = working load limit (4:1)

DK = diameter ketting  
DK = diameter chain

kl = kleur  
kl = colour

Artikelnr.	Type	WLL	DK	kl	kg/stuk
Part no.		ton	mm	kl	kg/piece
48101005	L-CB-S05	0,5	6x18 (1x)	rood / red	10
48101010	L-CB-S10	1,0	6x18 (1x)	rood / red	12
48101020	L-CB-S20	2,0	8x24 (1x)	rood / red	20
48101030	L-CB-S30	3,0	8x24 (2x)	rood / red	27
48101050	L-CB-S50	5,0	10x30 (2x)	rood / red	46
48101100	L-CB-S100	10,0	10x30 (4x)	rood / red	83
48102005	L-CB-B05	0,5	6x18 (1x)	zwart / black	10
48102010	L-CB-B10	1,0	6x18 (1x)	zwart / black	12

## Lewis rateltakel Lewis lever block

| Standaard hijshoogte 1,5 meter  
| Standard lift 1,5 metres



WLL = veilige belasting (4:1)  
WLL = working load limit (4:1)

DK = diameter ketting  
DK = diameter chain

Artikelnr.	Type	WLL	DK	kg/stuk
Part no.		ton	mm	kg/piece
482010025	L-LB-A025	0,25	4x12 (1x)	2,1
48201005	L-LB-A05	0,50	5x15 (1x)	3
482010075	L-LB-S075	0,75	6x18 (1x)	7
48201015	L-LB-S15	1,5	8x24 (1x)	11
48201030	L-LB-S30	3,0	10x30 (1x)	21
48201060	L-LB-S60	6,0	10x30 (2x)	31
48201090	L-LB-S90	9,0	10x30 (3x)	46

### Lewis sjortakel / stompe haken

### Lewis lever block / lashing hooks

| Standaard hijshoogte 1,5 meter  
| Standard lift 1,5 metres



WLL = veilige belasting (4:1)  
WLL = working load limit (4:1)

DK = diameter ketting  
DK = diameter chain

LC = lashing capaciteit  
LC = lashing capacity

Artikelnr.	Type	WLL	DK	LC	kg/stuk
Part no.		ton	mm	kg	kg/piece
48221015	L-LB-L15	1,5	8x24 (1x)	3.000	11
48221030	L-LB-L30	3,0	10x30 (1x)	6.000	21

### Lewis loopkat

### Lewis plain trolley



WLL = veilige belasting (4:1)  
WLL = working load limit (4:1)

Artikelnr.	Type	WLL	Min	Max	kg/stuk
Part no.		ton	mm	mm	kg/piece
48341005	L-PT-S05	0,5	50	220	5
48341010	L-PT-S10	1,0	58	220	8,7
48341020	L-PT-S20	2,0	66	220	13,9
48341030	L-PT-S30	3,0	74	220	23
48341050	L-PT-S50	5,0	90	220.	40

## Lewis balkklem

### Lewis beam clamp

WLL = veilige belasting (4:1)  
WLL = working load limit (4:1)

kl = kleur  
kl = colour



Artikelnr.	Type	WLL	kl	Min	Max	kg/stuk
Part no.		ton	kl	mm	mm	kg/piece
48301010	L-BC-S10	1,0	rood / red	75	220	4,5
48301020	L-BC-S20	2,0	rood / red	75	220	5
48301030	L-BC-S30	3,0	rood / red	80	320	10
48301050	L-BC-S50	5,0	rood / red	80	320	11
48321020	L-BC-B20	2,0	zwart / black	75	220	5

## Lewis takelketting / G80 / verzinkt

### Lewis hoist chain / G80 / electro galvanised

| EN 818-7

| EN 818-7

WLL = veilige belasting (4:1)  
WLL = working load limit (4:1)

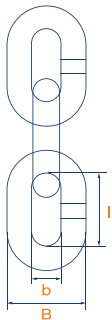

Artikelnr.	D	B	b	l	WLL	kg/100m
Part no.	mm	mm	mm	mm	kg	kg/100m
489090500412	4	13,2	5,2	12,0	500	36
489090500618	6	19,8	7,8	18,0	1.150	80
48909050063191	6,3	22,0	7,8	19,1	1.300	86
489090500721	7	23,1	8,7	21,0	1.500	108
4890905007212	7,1	25,0	8,8	21,2	1.600	108
489090500824	8	27,2	9,6	24,0	2.000	149
489090500927	9	29,7	11,5	27,0	2.500	185
489090501030	10	34,0	12,0	30,0	3.200	219
489090550618	6 (zwart) / 6 (black)	20,4	7,2	18,0	1.150	80

**Lewis bedieningsketting**  
**Lewis hand chain**



d = diameter  
d = diameter

kl = kleur  
kl = colour

Artikelnr.	d	a	b	kl	kg/100m
Part no.	mm	mm	mm	kl	kg/100m
489090100525	5.	25.	7,05.		36.
489090150525	5	25	7,05	zwart / black	36

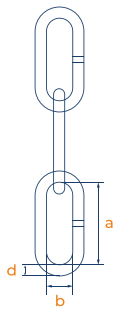

**Lewis staaldraadtrekker**  
**Lewis wire rope pulling hoist**

| Inclusief 20 meter staaldraad  
| Including 20 meter wire rope



WLL = veilige belasting  
WLL = working load limit

d = voor kabel in mm  
d = for steel wire rope

Artikelnr.	Type	WLL	d	kg/stuk
Part no.		ton	mm	kg/piece
4850100800	L-PH-0800	0,8	8,3	6
4850101600	L-PH-1600	1,6	11,0	12
4850103200	L-PH-3200	3,2	16,0	23



### Lewis draadspankikker Lewis steel wire rope grip puller

| Voor maximale treksterkte van 1770 N/mm<sup>2</sup>  
| For maximum tensile strength of 1770 N/mm<sup>2</sup>



a = voor kabel  
a = for steel wire rope

LC = lashing capaciteit  
LC = lashing capacity

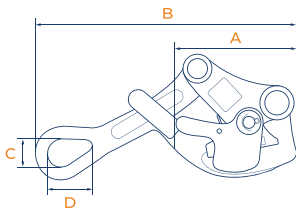

Artikelnr.	Type	A	D	a	B	C	LC	kg/stuk
Part no.		mm	mm	mm	mm	mm	kg	kg/piece
4856100500	L-DSK-05	55	16	1-10	131	16	500	0,45
4856101000	L-DSK-10	71	37	2,5-16	189	25	1000	0,75
4856102000	L-DSK-20	91	42	4-22	248	25	2000	1,5
4856103000	L-DSK-30	129	50	16-32	296	30	3000	2,5

### Lewis bovenhaak voor Lewis handkettingtakel / G80 Lewis top hook for Lewis chain block / G80

WLL = veilige belasting  
WLL = working load limit



Artikelnr.	Voor type	WLL	kg/stuk
Part no.	For type	ton	kg/piece
4890101023005	L-CB-S05	0,5	0,36
4890101023010	L-CB-S10	1,0	0,62
4890101023020	L-CB-S20	2,0	1,14
4890101023030	L-CB-S30	3,0	2,45
4890101023050	L-CB-S50	5,0	3,30
4890101023100	L-CB-S100	10,0	15,15

### Lewis onderhaak voor Lewis handkettingtakel / G80 Lewis bottom hook for Lewis chain hoist / G80

WLL = veilige belasting  
WLL = working load limit



Artikelnr.	Voor type	WLL	kg/stuk
Part no.	For type	ton	kg/piece
4890101007005	L-CB-S05	0,5	0,34
4890101007010	L-CB-S10	1,0	0,65
4890101007020	L-CB-S20	2,0	1,18
4890101007030	L-CB-S30	3,0	3,22
4890101007050	L-CB-S50	5,0	4,86
4890101007100	L-CB-S100	10,0	18,66

### Lewis gesmede klepset voor Lewis handkettingtakel Lewis forged latch set for Lewis chain hoist

| Inhoud set: klep, veer en stift  
| Set contains: latch, spring and pin

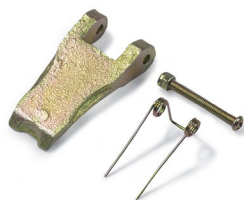

Artikelnr.	Voor type	kg/stuk
Part no.	For type	kg/piece
4890101008005	L-CB-S05	0,03
4890101008010	L-CB-S10	0,04
4890101008020	L-CB-S20	0,06
4890101008030	L-CB-S30	0,10
4890101008050	L-CB-S50	0,14
4890101008100	L-CB-S100	0,20

### Lewis remschijf voor Lewis handkettingtakel Lewis friction disk for Lewis chain hoist



Artikelnr.	Voor type	kg/stuk
Part no.	For type	kg/piece
4890101028005	L-CB-S05	0,02
4890101028010	L-CB-S10	0,04
4890101028030	L-CB-S20 & L-CB-S30	0,06
4890101028100	L-CB-S50 & L-CB-S100	0,09

### Lewis bovenhaak voor Lewis rateltakel / G80 Lewis top hook for Lewis lever block / G80



WLL = veilige belasting  
WLL = working load limit



Artikelnr.	Voor type	WLL	kg/stuk
Part no.	For type	ton	kg/piece
4890201031025	L-LB-S025	0,25	0,24
4890201031075	L-LB-S075	0,75	0,49
4890201031115	L-LB-S15	1,5	0,93
489020103130	L-LB-S30	3,0	2,07
489020103160	L-LB-S60	6,0	4,60
489020103190	L-LB-S90	9,0	9,90

**Lewis onderhaak voor Lewis rateltakel / G80**  
**Lewis bottom hook for Lewis lever block / G80**

WLL = veilige belasting  
 WLL = working load limit



Artikelnr.	Voor type	WLL	kg/stuk
Part no.	For type	ton	kg/piece
4890201033025	L-LB-S025	0,25	0,23
4890201033075	L-LB-S075	0,75	0,53
489020103315	L-LB-S15	1,5	0,96
489020103330	L-LB-S30	3,0	2,23
489020103360	L-LB-S60	6,0	6,65
489020103390	L-LB-S90	9,0	10

**Lewis gesmede klepset voor Lewis rateltakel**  
**Lewis forged latch set for Lewis lever block**

| Inhoud set: klep, veer en stift  
 | Set contains: latch, spring and pin



Artikelnr.	Voor type	kg/stuk
Part no.	For type	kg/piece
4890201061025	L-LB-S025	0,02
4890201061075	L-LB-S075	0,04
489020106115	L-LB-S15	0,06
489020106130	L-LB-S30	0,10
489020106160	L-LB-S60	0,14
489020106190	L-LB-S90	0,20



### Lewis remschijf voor Lewis rateltakel Lewis friction disk for Lewis lever block



Artikelnr.	Voor type	kg/stuk
Part no.	For type	kg/piece
4890201017025	L-LB-S025	0,01
4890201017075	L-LB-S075	0,04
489020101715	L-LB-S15	0,05
489020101790	L-LB-S30 & L-LB-S60 & L-LB-S90	0,09

### Lewis bovenhaak voor Lewis sjortakel / G80 Lewis top hook for Lewis lashing lever block / G80



WLL = veilige belasting  
WLL = working load limit

LC = lashing capaciteit  
LC = lashing capacity

Artikelnr.	Voor type	WLL	LC	kg/stuk
Part no.	For type	ton	kg	kg/piece
489022103115	L-LB-L15	1,5	3.000	0,93
489022103130	L-LB-L30	3,0	6.000	2,07

### Lewis onderhaak voor Lewis sjortakel / G80 Lewis bottom hook for Lewis lashing block / G80



WLL = veilige belasting  
WLL = working load limit

LC = lashing capaciteit  
LC = lashing capacity

Artikelnr.	Voor type	WLL	LC	kg/stuk
Part no.	For type	ton	kg	kg/piece
489022103315	L-LB-L15	1,5	3.000	0,96
489022103330	L-LB-L30	3,0	6.000	2,23

Lewis kettingzak voor Lewis handkettingtakel  
Lewis chain bag for Lewis chain block



Artikelnr.	Voor type	Capaciteit	kg/stuk
Part no.	For type	Capacity	kg/piece
48109010	L-CB-B05/S05 & L-CB-B10/S10	6mmx12m	0,6
48109020	L-CB-S20	8mmx12m	0,7

Lewis klapblok / enkele schijf  
Lewis snatch block / single sheave

| Met haak  
| With hook

WLL = veilige belasting (4:1)  
WLL = working load limit (4:1)

d = voor kabel in mm  
d = for steel wire rope

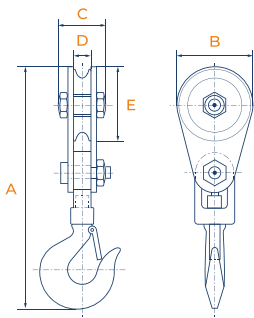

Artikelnr.	WLL	d	A	D	B	C	E	kg/stuk
Part no.	ton	mm	mm	mm	mm	mm	mm	kg/piece
486010100200	2	10	241	22	76	63	74	2,35
486010100400	4	12	360	34,5	108	82,5	104,5	6,33
486010100800	8	20	525	40,5	152	93	150	16,7



